

Core Pins

Plastixs Core Pins are precision ground and through-hardened. They are made of H-13 Hotwork Die Steel material.

Standard Hardness: 30-35 Rc

High Hardness: 50-55 Rc

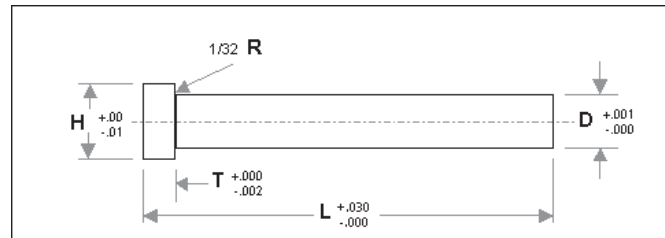

Standard Hardness Specifications

D Nom. Pin Dia.	H Head Diameter	T Head Thcknss	L = 3"		L = 6"		L = 10"	
			Cat. No.	Price	Cat. No.	Price	Cat. No.	Price
3/32	1/4	1/8	PC1-094L3	\$3.83	PC1-094L6	\$3.94	PC1-094L10	\$4.57
7/64	1/4	1/8	PC1-109L3	\$3.94	PC1-109L6	\$3.99	PC1-109L10	\$4.84
1/8	1/4	1/8	PC1-125L3	\$2.39	PC1-125L6	\$2.50	PC1-125L10	\$3.30
9/64	1/4	1/8	PC1-141L3	\$2.39	PC1-141L6	\$2.55	PC1-141L10	\$3.30
5/32	9/32	5/32	PC1-156L3	\$2.50	PC1-156L6	\$2.61	PC1-156L10	\$3.35
11/64	11/32	3/16	PC1-172L3	\$2.50	PC1-172L6	\$2.61	PC1-172L10	\$3.46
3/16	3/8	3/16	PC1-187L3	\$2.55	PC1-187L6	\$2.66	PC1-187L10	\$3.51
13/64	3/8	3/16	PC1-203L3	\$2.61	PC1-203L6	\$2.71	PC1-203L10	\$3.51
7/32	13/32	3/16	PC1-219L3	\$2.66	PC1-219L6	\$2.77	PC1-219L10	\$3.62
1/4	7/16	3/16	PC1-250L3	\$2.82	PC1-250L6	\$2.93	PC1-250L10	\$3.88
9/32	7/16	1/4	PC1-281L3	\$3.14	PC1-281L6	\$3.24	PC1-281L10	\$4.20
5/16	1/2	1/4	PC1-312L3	\$3.46	PC1-312L6	\$3.51	PC1-312L10	\$4.68
11/32	9/16	1/4	PC1-344L3	\$3.67	PC1-344L6	\$3.83	PC1-344L10	\$5.00
3/8	5/8	1/4	PC1-375L3	\$3.99	PC1-375L6	\$4.20	PC1-375L10	\$5.64
13/32	11/16	1/4	PC1-406L3	\$4.36	PC1-406L6	\$4.57	PC1-406L10	\$6.06
7/16	11/16	1/4	PC1-437L3	\$4.84	PC1-437L6	\$4.95	PC1-437L10	\$6.60
15/32	3/4	1/4	PC1-469L3	\$5.00	PC1-469L6	\$5.53	PC1-469L10	\$7.13
1/2	3/4	1/4	PC1-500L3	\$5.69	PC1-500L6	\$5.90	PC1-500L10	\$7.71
9/16	13/16	1/4			PC1-563L6	\$6.86	PC1-563L10	\$9.15
5/8	7/8	1/4			PC1-625L6	\$7.93	PC1-625L10	\$10.74
3/4	1	1/4			PC1-750L6	\$11.12	PC1-750L10	\$14.52

Minimum quantity order may apply

High Hardness Specifications

D Nom. Pin Dia.	H Head Diameter	T Head Thcknss	L = 3"		L = 6"		L = 10"	
			Cat. No.	Price	Cat. No.	Price	Cat. No.	Price
3/32	1/4	1/8	PC2-094L3	\$3.94	PC2-094L6	\$4.20	PC2-094L10	\$4.95
7/64	1/4	1/8	PC2-109L3	\$4.15	PC2-109L6	\$4.31	PC2-109L10	\$5.16
1/8	1/4	1/8	PC2-125L3	\$2.61	PC2-125L6	\$2.71	PC2-125L10	\$3.46
9/64	1/4	1/8	PC2-141L3	\$2.61	PC2-141L6	\$2.77	PC2-141L10	\$3.46
5/32	9/32	5/32	PC2-156L3	\$2.71	PC2-156L6	\$2.77	PC2-156L10	\$3.46
11/64	11/32	3/16	PC2-172L3	\$2.77	PC2-172L6	\$2.82	PC2-172L10	\$3.62
3/16	3/8	3/16	PC2-187L3	\$2.77	PC2-187L6	\$2.87	PC2-187L10	\$3.62
13/64	3/8	3/16	PC2-203L3	\$2.77	PC2-203L6	\$2.93	PC2-203L10	\$3.78
7/32	13/32	3/16	PC2-219L3	\$2.82	PC2-219L6	\$2.98	PC2-219L10	\$3.78
1/4	7/16	3/16	PC2-250L3	\$2.98	PC2-250L6	\$3.24	PC2-250L10	\$3.99
9/32	7/16	1/4	PC2-281L3	\$3.40	PC2-281L6	\$3.51	PC2-281L10	\$4.57
5/16	1/2	1/4	PC2-312L3	\$3.67	PC2-312L6	\$3.83	PC2-312L10	\$5.00
11/32	9/16	1/4	PC2-344L3	\$3.99	PC2-344L6	\$4.20	PC2-344L10	\$5.64
3/8	5/8	1/4	PC2-375L3	\$4.36	PC2-375L6	\$4.63	PC2-375L10	\$6.12
13/32	11/16	1/4	PC2-406L3	\$4.68	PC2-406L6	\$4.95	PC2-406L10	\$6.60
7/16	11/16	1/4	PC2-437L3	\$5.21	PC2-437L6	\$5.53	PC2-437L10	\$7.18
15/32	3/4	1/4	PC2-469L3	\$5.64	PC2-469L6	\$5.96	PC2-469L10	\$7.87
1/2	3/4	1/4	PC2-500L3	\$6.12	PC2-500L6	\$6.38	PC2-500L10	\$8.56
9/16	13/16	1/4			PC2-563L6	\$7.45	PC2-563L10	\$9.95
5/8	7/8	1/4			PC2-625L6	\$8.78	PC2-625L10	\$11.76
3/4	1	1/4			PC2-750L6	\$12.07	PC2-750L10	\$16.12

Minimum quantity order may apply