

Ejector Pins - Straight Style

Plastixs Ejector Pins are precision ground and nitrided for wear resistance.

Material: H-13

Core hardness: 40-45 Rc

Surface hardness: Nitrided to 65-80 Rc

Surface finish: 4-10 RMS



D Nominal Pin Dia.	H Head Dia.	T Head Thkness	L = 6"		L = 10"		L = 10"		L = 14"		L = 14"	
			Standard Diameter	Price	Standard Diameter	Price	Oversized Dia. (.005)	Price	Standard Diameter	Price	Oversized Dia. (.005)	Price
3/64	1/4	1/8	PE1-047L6	\$4.68								
1/16	1/4	1/8	PE1-062L6	\$4.36								
5/64	1/4	1/8	PE1-078L6	\$4.36								
3/32	1/4	1/8	PE1-094L6	\$3.94	PE1-094L10	\$4.41						
7/64	1/4	1/8	PE1-109L6	\$3.94	PE1-109L10	\$4.41						
1/8	1/4	1/8	PE1-125L6	\$2.13	PE1-125L10	\$2.39	PE1-130L10	\$2.55	PE1-125L14	\$2.98	PE1-130L14	\$2.98
9/64	1/4	1/8			PE1-141L10	\$2.55			PE1-141L14	\$3.24		
5/32	9/32	5/32	PE1-156L6	\$2.23	PE1-156L10	\$2.55	PE1-161L10	\$2.66	PE1-156L14	\$2.98	PE1-161L14	\$3.30
11/64	11/32	3/16			PE1-172L10	\$2.71			PE1-172L14	\$3.35		
3/16	3/8	3/16	PE1-187L6	\$2.29	PE1-187L10	\$2.71	PE1-192L10	\$2.82	PE1-187L14	\$3.30	PE1-192L14	\$3.51
13/64	3/8	3/16			PE1-203L10	\$2.93			PE1-203L14	\$3.51		
7/32	13/32	3/16	PE1-219L6	\$2.50	PE1-219L10	\$2.98	PE1-224L10	\$3.14	PE1-219L14	\$3.62		
15/64	13/32	3/16			PE1-234L10	\$3.24			PE1-234L14	\$3.94		
1/4	7/16	3/16	PE1-250L6	\$2.66	PE1-250L10	\$3.30	PE1-255L10	\$3.46	PE1-250L14	\$3.94	PE1-255L14	\$4.31
17/64	7/16	1/4			PE1-266L10	\$3.66			PE1-266L14	\$4.36		
9/32	7/16	1/4	PE1-281L6	\$2.98	PE1-281L10	\$3.78	PE1-286L10	\$3.88	PE1-281L14	\$4.52		
19/64	1/2	1/4			PE1-297L10	\$3.99			PE1-297L14	\$5.00		
5/16	1/2	1/4	PE1-312L6	\$3.30	PE1-312L10	\$4.20	PE1-317L10	\$4.31	PE1-312L14	\$5.00	PE1-317L14	\$5.43
21/64	9/16	1/4			PE1-328L10	\$4.52			PE1-328L14	\$5.64		
11/32	9/16	1/4	PE1-344L6	\$3.67	PE1-344L10	\$4.73	PE1-349L10	\$4.89	PE1-344L14	\$5.90		
23/64	5/8	1/4			PE1-359L10	\$5.00			PE1-359L14	\$6.33		
3/8	5/8	1/4	PE1-375L6	\$3.88	PE1-375L10	\$5.21	PE1-380L10	\$5.43	PE1-375L14	\$6.38	PE1-380L14	\$6.76
13/32	11/16	1/4	PE1-406L6	\$4.31	PE1-406L10	\$5.80	PE1-411L10	\$6.06	PE1-406L14	\$7.23		
7/16	11/16	1/4	PE1-437L6	\$4.73	PE1-437L10	\$6.38	PE1-442L10	\$6.60	PE1-437L14	\$8.03	PE1-442L14	\$8.56
15/32	3/4	1/4			PE1-469L10	\$6.97	PE1-474L10	\$7.18				
1/2	3/4	1/4	PE1-500L6	\$5.64	PE1-500L10	\$7.55	PE1-505L10	\$7.87	PE1-500L14	\$9.67	PE1-505L14	\$10.21
9/16	13/16	1/4	PE1-562L6	\$6.70	PE1-562L10	\$9.15			PE1-562L14	\$11.54		
5/8	7/8	1/4	PE1-625L6	\$7.77	PE1-625L10	\$10.69			PE1-625L14	\$13.46		
11/16	15/16	1/4			PE1-687L10	\$12.61						
3/4	1	1/4	PE1-750L6	\$10.74	PE1-750L10	\$14.41			PE1-750L14	\$18.35		
7/8	1-1/8	1/4			PE1-875L10	\$20.00						
1	1-1/4	1/4	PE1-1000L6	\$16.91	PE1-1000L10	\$23.10			PE1-1000L14	\$29.68		

Minimum quantity order may apply

additional sizes available, call for details

Ejector Pins - Shoulder Style

Plastixs Shoulder Style Ejector Pins are precision ground and nitrided for wear resistance.

Material: H-13

Core hardness: 40-45 Rc

Surface hardness: Nitrided to 65-80 Rc

Surface finish: 4-10 RMS

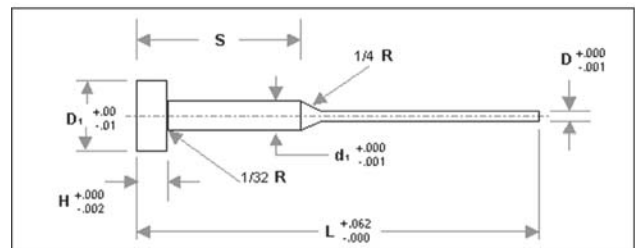

D Pin Diameter	d ₁ Nom. Pin Dia.	D ₁ Head Diameter	T Head Thkness	S Shldr Length	L = 6"		L = 10"		L = 10"	
					Standard Diameter	Price	Standard Diameter	Price	Oversized Dia. (.005)	Price
3/64	1/8	1/4	1/8	1/2	PE2-047L6-05	\$4.57	PE2-047L10-05	\$5.53	PE2-052L10-05	\$6.06
3/64	1/8	1/4	1/8	2	PE2-047L6-20	\$4.47	PE2-047L10-20	\$5.21	PE2-052L10-20	\$5.80
1/16	1/8	1/4	1/8	1/2	PE2-062L6-05	\$4.31	PE2-062L10-05	\$5.00	PE2-067L10-05	\$5.69
1/16	1/8	1/4	1/8	2	PE2-062L6-20	\$4.20	PE2-062L10-20	\$4.89	PE2-067L10-20	\$5.53
5/64	1/8	1/4	1/8	1/2	PE2-078L6-05	\$4.31	PE2-078L10-05	\$5.00	PE2-083L10-05	\$5.69
5/64	1/8	1/4	1/8	2	PE2-078L6-20	\$4.20	PE2-078L10-20	\$4.89	PE2-083L10-20	\$5.53
3/32	1/8	1/4	1/8	1/2	PE2-094L6-05	\$3.88	PE2-094L10-05	\$4.68	PE2-099L10-05	\$5.21
3/32	1/8	1/4	1/8	2	PE2-094L6-20	\$3.78	PE2-094L10-20	\$4.41	PE2-099L10-20	\$4.95
7/64	1/8	1/4	1/8	1/2	PE2-109L6-05	\$3.88	PE2-109L10-05	\$4.68	PE2-114L10-05	\$5.21
7/64	1/8	1/4	1/8	2	PE2-109L6-20	\$3.78	PE2-109L10-20	\$4.41	PE2-114L10-20	\$4.95

Minimum quantity order may apply

additional sizes available, call for details