

Ejector Pins - Through Hardened

Plastixs Ejector Pins are through hardened to minimize dishing, nicking and bending. Made of a through-hardened steel.

Material: Through-hardened
Hardness: 58-62 Rc
Surface finish: 4-10 RMS

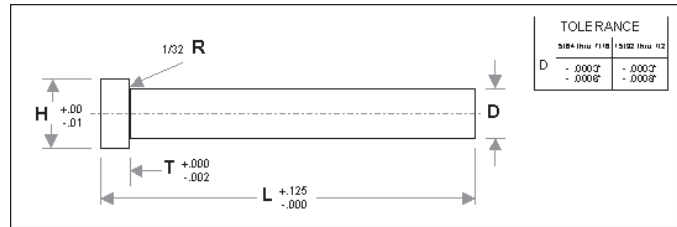

Nom. Pin Dia.	D Pin Diameter	H Head Diameter	T Head Thcknss	L = 6"		L = 10"		L = 14"	
				Cat. No.	Price	Cat. No.	Price	Cat. No.	Price
5/64	.0778/.0775	1/4	1/8	PE3-078L6	\$3.19	PE3-078L10	\$4.15		
3/32	.0935/.0932	1/4	1/8	PE3-094L6	\$2.77	PE3-094L10	\$4.18		
7/64	.1019/.1088	1/4	1/8	PE3-109L6	\$2.65	PE3-109L10	\$3.46		
1/8	.1247/.1244	1/4	1/8	PE3-125L6	\$1.97	PE3-125L10	\$2.39	PE3-125L14	\$2.82
9/64	.1403/.1400	1/4	1/8	PE3-141L6	\$2.13	PE3-141L10	\$2.50	PE3-141L14	\$3.30
5/32	.1560/.1557	9/32	5/32	PE3-156L6	\$2.29	PE3-156L10	\$2.82	PE3-156L14	\$3.51
11/64	.1716/.1713	11/32	3/16	PE3-172L6	\$2.29	PE3-172L10	\$2.82	PE3-172L14	\$3.51
3/16	.1872/.1869	3/8	3/16	PE3-187L6	\$2.29	PE3-187L10	\$2.82	PE3-187L14	\$3.56
13/64	.2028/.2025	3/8	3/16	PE3-203L6	\$2.45	PE3-203L10	\$3.03	PE3-203L14	\$3.72
7/32	.2185/.2182	13/32	3/16	PE3-218L6	\$2.55	PE3-218L10	\$3.14	PE3-218L14	\$3.83
15/64	.2341/.2338	13/32	3/16	PE3-234L6	\$2.71	PE3-234L10	\$3.35	PE3-234L14	\$4.20
1/4	.2497/.2494	7/16	3/16	PE3-250L6	\$2.71	PE3-250L10	\$3.40	PE3-250L14	\$4.20
17/64	.2653/.2650	7/16	1/4	PE3-265L6	\$3.11	PE3-265L10	\$3.78	PE3-265L14	\$4.63
9/32	.2810/.2807	7/16	1/4	PE3-281L6	\$3.14	PE3-281L10	\$3.88	PE3-281L14	\$4.79
19/64	.2966/.2963	1/2	1/4	PE3-297L6	\$3.40	PE3-297L10	\$4.20	PE3-297L14	\$5.27
5/16	.3122/.3119	1/2	1/4	PE3-313L6	\$3.40	PE3-313L10	\$4.31	PE3-313L14	\$5.27
21/64	.3278/.3275	9/16	1/4	PE3-328L6	\$3.83	PE3-328L10	\$4.79	PE3-328L14	\$6.01
11/32	.3435/.3432	9/16	1/4	PE3-343L6	\$3.88	PE3-343L10	\$5.00	PE3-343L14	\$6.22
23/64	.3591/.3588	5/8	1/4	PE3-359L6	\$4.04	PE3-359L10	\$5.32	PE3-359L14	\$6.65
3/8	.3747/.3744	5/8	1/4	PE3-375L6	\$4.10	PE3-375L10	\$5.48	PE3-375L14	\$6.70
13/32	.4060/.4057	11/16	1/4	PE3-406L6	\$4.52	PE3-406L10	\$6.17	PE3-406L14	\$7.61
7/16	.4372/.4369	11/16	1/4	PE3-438L6	\$4.95	PE3-438L10	\$7.07	PE3-438L14	\$8.56
15/32	.4684/.4679	3/4	1/4	PE3-469L6	\$5.74	PE3-469L10	\$7.34	PE3-469L14	\$9.73
1/2	.4997/.4992	3/4	1/4	PE3-500L6	\$5.85	PE3-500L10	\$7.93	PE3-500L14	\$9.95

Minimum quantity order may apply

Ejector Pins - Through-Hardened Shoulder Style

Plastixs Shoulder Style Through-hardened Ejector Pins are through-hardened to minimize dishing, nicking and bending. They are made of a through-hardened 'high speed steel', 58-62 Rc with a surface finish of 4-10 RMS.

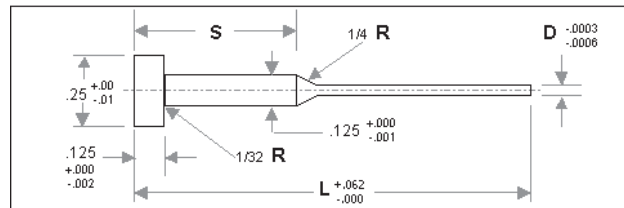

Nom. Pin Dia.	D Pin Diameter	S Shoulder Length	L = 6"		L = 10"	
			Cat. No.	Price	Cat. No.	Price
3/64	.0466/.0463	1/2	PE4-047L6-05	\$8.35	PE4-047L10-05	\$9.79
3/64	.0466/.0463	2	PE4-047L6-20	\$7.98	PE4-047L10-20	\$9.31
1/16	.0622/.0619	1/2	PE4-062L6-05	\$7.50	PE4-062L10-05	\$8.62
1/16	.0622/.0619	2	PE4-062L6-20	\$7.18	PE4-062L10-20	\$7.98
5/64	.0778/.0775	1/2	PE4-078L6-05	\$7.45	PE4-078L10-05	\$8.35
5/64	.0778/.0775	2	PE4-078L6-20	\$7.07	PE4-078L10-20	\$8.67
3/32	.0935/.0932	1/2	PE4-094L6-05	\$6.70	PE4-094L10-05	\$7.82
3/32	.0935/.0932	2	PE4-094L6-20	\$6.60	PE4-094L10-20	\$7.45
7/64	.1091/.1088	1/2	PE4-109L6-05	\$6.65	PE4-109L10-05	\$7.71
7/64	.1091/.1088	2	PE4-109L6-20	\$6.33	PE4-109L10-20	\$7.77

Minimum quantity order may apply