

Metric Ejector Pins

Plastixs Metric Ejector Pins are precision ground and nitrided for wear resistance. They are made of H-13 material with a core hardness of 35-40 Rc. Their case hardness is nitrided to 65-80 Rc with a surface finish of 4-5 micron.

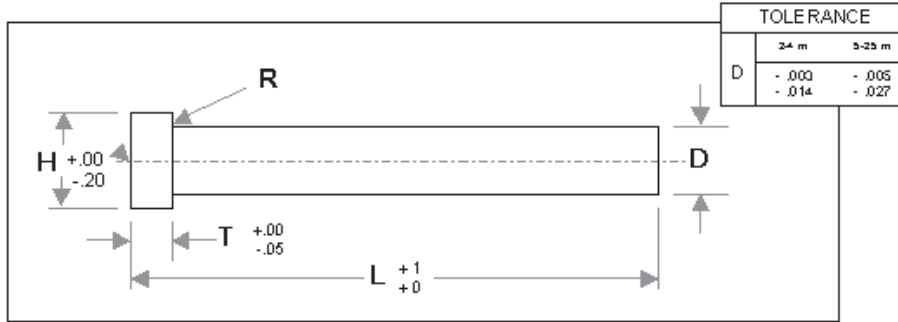

Note: All dimensions and tolerances are in millimeters

| D Pin Diameter | H Head Diameter | T Head Thickness | R Radius | L = 125mm | | L = 200mm | | L = 250mm | |
|----------------------|-----------------------|------------------------|-------------|-------------|--------|-------------|---------|-------------|---------|
| | | | | Cat. No. | Price | Cat. No. | Price | Cat. No. | Price |
| 2.0 (.0787) | 4 (.1574) | 2 (.0787) | 0.2 (.0078) | PE7-02L125 | \$3.30 | PE7-02L200 | \$3.78 | PE7-025L250 | \$3.78 |
| 2.5 (.0984) | 5 (.1968) | 2 (.0787) | 0.3 (.0118) | PE7-025L125 | \$3.40 | PE7-025L200 | \$4.26 | PE7-025L250 | \$3.78 |
| 3.0 (.1181) | 6 (.2362) | 3 (.1181) | 0.3 (.0118) | PE7-03L125 | \$2.71 | PE7-03L200 | \$3.72 | PE7-03L250 | \$3.94 |
| 4.0 (.1574) | 8 (.3149) | 3 (.1181) | 0.3 (.0118) | PE7-04L125 | \$2.87 | PE7-04L200 | \$4.15 | PE7-04L250 | \$4.31 |
| 5.0 (.1968) | 10 (.3937) | 3 (.1181) | 0.3 (.0118) | PE7-05L125 | \$3.14 | PE7-05L200 | \$3.78 | PE7-05L250 | \$3.99 |
| 6.0 (.2362) | 12 (.4724) | 5 (.1968) | 0.5 (.0196) | PE7-06L125 | \$3.78 | PE7-06L200 | \$4.84 | PE7-06L250 | \$5.53 |
| 8.0 (.3149) | 14 (.5511) | 5 (.1968) | 0.5 (.0196) | PE7-08L125 | \$4.63 | PE7-08L200 | \$6.44 | PE7-08L250 | \$7.45 |
| 10.0 (.3937) | 16 (.6299) | 5 (.1968) | 0.5 (.0314) | PE7-10L125 | \$5.37 | PE7-10L200 | \$7.66 | PE7-10L250 | \$8.88 |
| 12.0 (.4724) | 20 (.7874) | 7 (.2755) | 0.8 (.0314) | PE7-12L125 | \$6.97 | PE7-12L200 | \$8.67 | PE7-12L250 | \$10.11 |
| 14.0 (.5511) | 22 (.8661) | 7 (.2755) | 0.8 (.0314) | | | PE7-14L200 | \$11.22 | PE7-14L250 | \$13.03 |
| 16.0 (.6299) | 22 (.8661) | 7 (.2755) | 0.8 (.0314) | | | PE7-16L200 | \$12.66 | PE7-16L250 | \$15.00 |
| 18.0 (.7086) | 26 (1.0236) | 7 (.2755) | 0.8 (.0314) | | | | | PE7-18L250 | \$19.68 |
| 20.0 (.7874) | 26 (1.0236) | 8 (.3149) | 1.0 (.0393) | | | PE7-20L200 | \$19.68 | PE7-20L250 | \$23.03 |
| 25.0 (.9842) | 32 (1.2598) | 10 (.3149) | 1.0 (.0393) | | | PE7-25L200 | \$35.00 | PE7-25L250 | \$40.16 |

Minimum quantity order may apply

additional sizes available, call for details