

**POWERTECH**  
C O M P O N E N T S

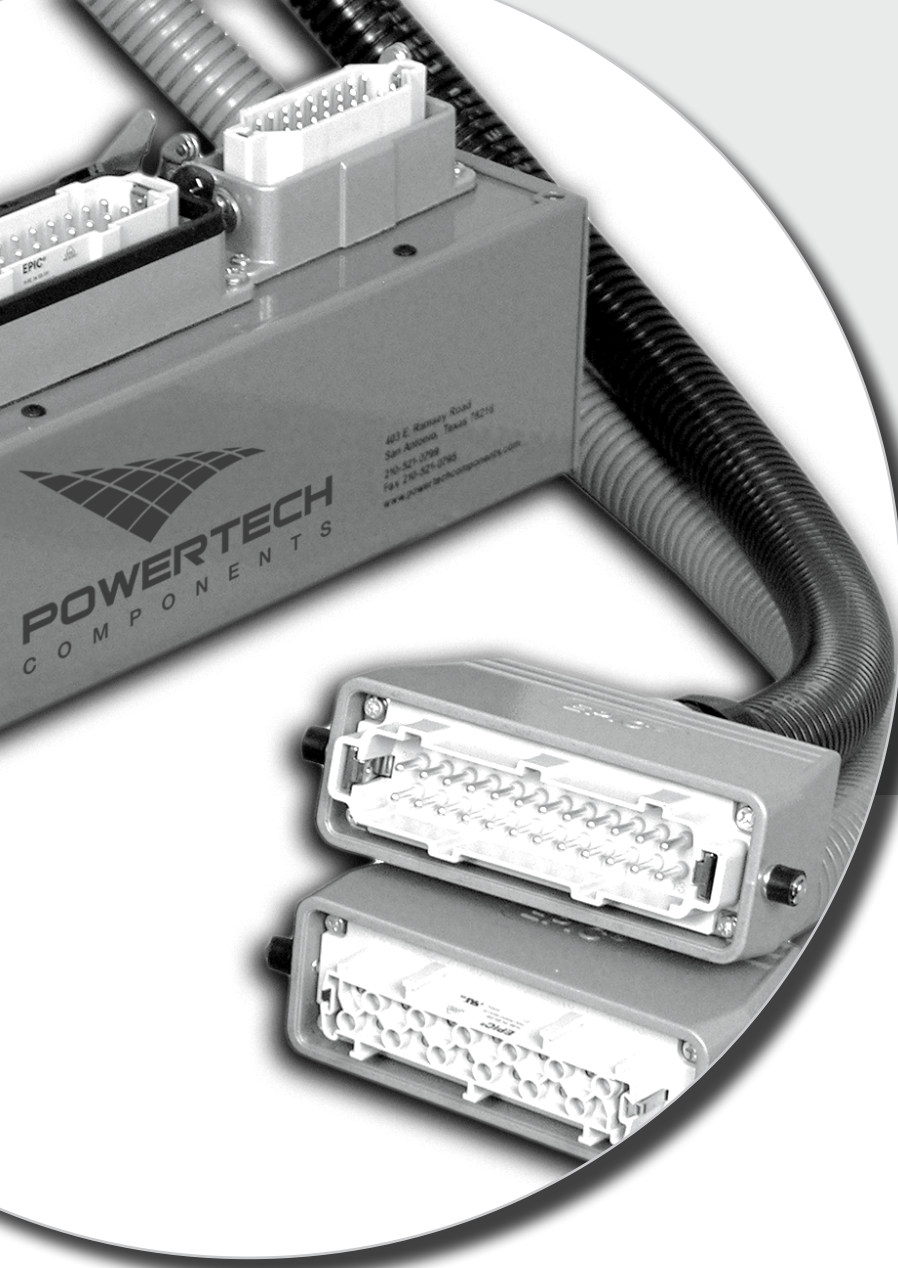

# CATALOG

<b>TITAN TECHNOLOGY .....</b>	<b>1</b>
<b>DME® TYPE CONNECTORS</b>	
<b>MOLD WIRING SYSTEMS .....</b>	<b>1</b>
<b>CABLE ASSEMBLIES .....</b>	<b>2</b>
<b>EPIC® TYPE CONNECTORS</b>	
<b>CABLE ASSEMBLIES .....</b>	<b>3</b>
<b>MOLD WIRING SYSTEMS .....</b>	<b>5</b>
<b>SPECIAL SOLUTIONS</b>	
<b>TRANSITION CABLES &amp; SYSTEMS.....</b>	<b>7</b>
<b>CONNECTOR IDENTIFICATION .....</b>	<b>9</b>

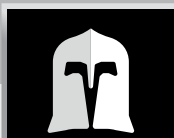

**TITAN**

**CONNECTIONS**

## TITAN CONNECTION TECHNOLOGY

**ELIMINATE** pin push out once and for all in **BOTH** the cable and the **Mold Connector** using **POWERTECH Titan Connections**

The benefits of using POWERTECH'S TITAN process are eliminating bad thermocouple readings, lost power output, lost production/lost capacity, down-time, and costly mold damage. **Learn more at [www.powertechcomponents.com](http://www.powertechcomponents.com)**



### D-M-E® POWER CABLE

	ZONES	PART #
Power Cables	12	CT-2512-15
Power Cables	8	CT-2508-15
Power Cables	5	CT-2505-15



### D-M-E® 12 ZONE THERMOCOUPLE CABLE

	ZONES	PART #
Thermocouple Cables	12	CT-4512-15



### D-M-E® 8 ZONE THERMOCOUPLE CABLE

	ZONES	PART #
Thermocouple Cables	8	CT-4508-15



### D-M-E® 5 ZONE THERMOCOUPLE CABLE

	ZONES	PART #
Thermocouple Cables	5	CT-4505-15

**DME® Power Cable Note:** With this type of cable 12, 8 & 5 Zone versions use the same connector with less pins installed on 5 & 8 Zones. You can use the 12 Zone cable for all three applications and reduce your in-house cable inventory.

# D-M-E® TYPE CONNECTORS

Hot Runner Wiring Systems

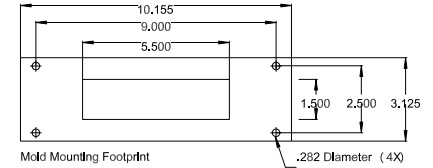
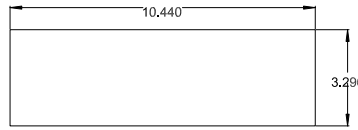
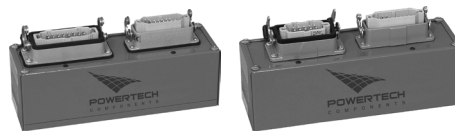

## D-M-E® 12, 8, 5 ZONES

- Power & Thermocouple Combination
- Power & Thermocouple Combination
- Power & Thermocouple Combination

ZONES	ITEM #
12	CT-0812
8	CT-0808
5	CT-0805

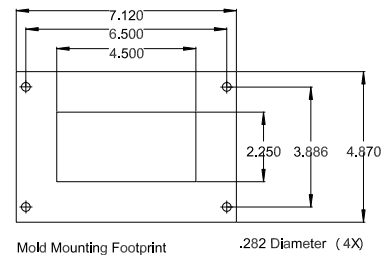
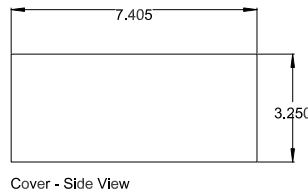
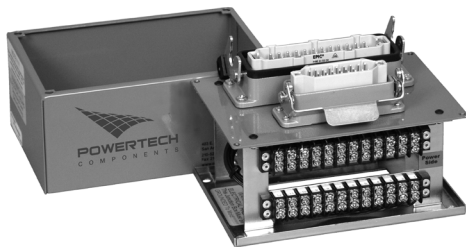

## D-M-E® TYPE 12-ZONE DM

- Power & Thermocouple Combination
- Power & Thermocouple Combination

ZONES	ITEM #
12	CT-8712-DM
8	CT-8708-DM

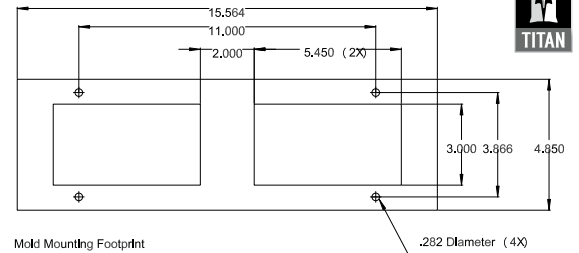
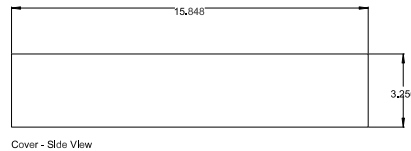

## D-M-E® TYPE 24,16-ZONE SHD

- Power & Thermocouple Combination
- Power & Thermocouple Combination

ZONES	ITEM #
24	CT-0624-SHD
16	CT-0616-SHD

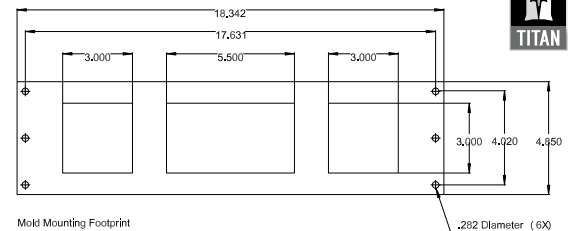
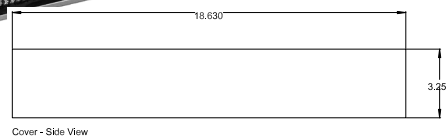
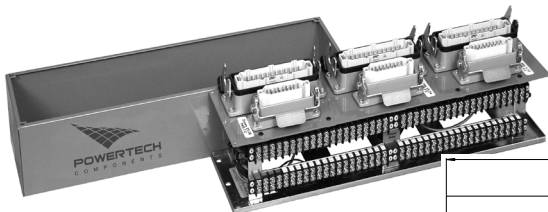

## D-M-E® TYPE 36-ZONE

- Power & Thermocouple Combination

ZONES	ITEM #
36	CX-0836



## 16-PIN HBE CABLES

	ZONES	PART #
Power Cables	8	CT-2408-15
Thermocouple Cables	8	CT-4408-15
Combination Power/Thermocouple Cables	4	CT-2604-15



## 24-PIN HBE CABLES

	ZONES	PART #
Power Cables	12	CT-2412-15
Thermocouple Cables	12	CT-4412-15
Combination Power/Thermocouple Cables	6	CT-2606-15



## 32-PIN HBE CABLES

	ZONES	PART #
Power Cables	16	CT-0216-15
Thermocouple Cables	16	CT-0416-15
Combination Power/Thermocouple Cables	8	CT-6608-15

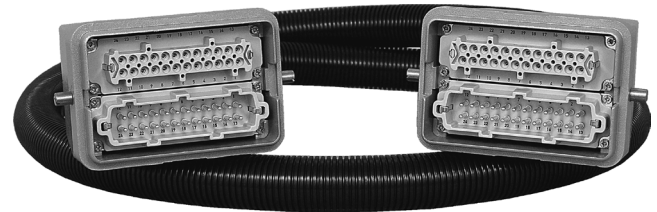

## 48-PIN HBE CABLES

	ZONES	PART #
Power Cables	24	CT-2424-15
Thermocouple Cables	24	CT-4424-15
Combination Power/Thermocouple Cables	12	CT-2612-15



## 4-PIN HA CABLES

	ZONES	PART #
Combination Power/Thermocouple Cables	1	CT-3501-15

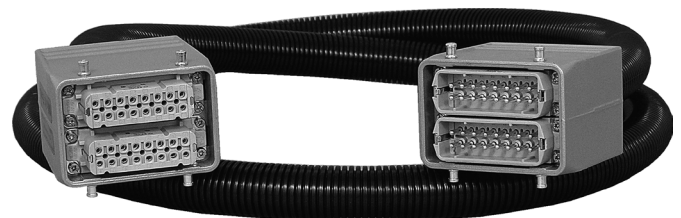

## 32-PIN HA CABLES

	ZONES	PART #
Power Cables	16	CT-7216-15
Thermocouple Cables	16	CT-7416-15
Combination Power/Thermocouple Cables	8	CT-7608-15



## 48-PIN HA CABLES

	ZONES	PART #
Power Cables	24	CT-7024-P-15
Thermocouple Cables	24	CT-7024-T-15



## 64-PIN HA CABLES

	ZONES	PART #
Combination Power/Thermocouple Cables	16	CT-7016-15



## 40-PIN HD CABLES

	ZONES	PART #
Power Cables	20	CT-5220-15
Thermocouple Cables	20	CT-5420-15
Combination Power/Thermocouple Cables	10	CT-5610-15



## 64-PIN HD CABLES

	ZONES	PART #
Power Cables	32	CT-5232-15
Thermocouple Cables	32	CT-5432-15
Combination Power/Thermocouple Cables	16	CT-5616-15



## 6-PIN HBS CABLES

	ZONES	PART #
Power Cables (High Amp)	3	CT-3003-15



## 12-PIN HBS CABLES

	ZONES	PART #
Power Cables (High Amp)	6	CT-3006-15



## 32-PIN EE CABLES

	ZONES	PART #
Power Cables	16	CT-9216-32EE-15
Thermocouple Cables	16	CT-9416-32EE-15

*EE Type Connectors are available with Iron and Constantan Pins*



## 46-PIN EE CABLES

	ZONES	PART #
Power Cables	23	CT-9232-15
Thermocouple Cables	23	CT-9432-15
Combination Power/Thermocouple Cables	11	CT-5711-46EE-15

*EE Type Connectors are available with Iron and Constantan Pins*



## 4 X 8 MIXED CABLES

	ZONES	PART #
Combination Power/Thermocouple Cables	2	CT-3702-15



## AMPHENOL ROUND MILITARY STYLE CABLES

	ZONES	PART #
Power Cables	24	MS-2224-15
Thermocouple Cables	18	MS-4418-15

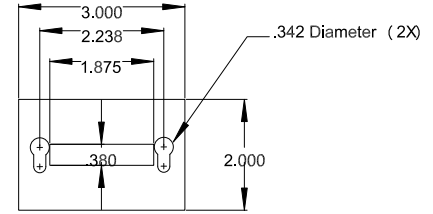
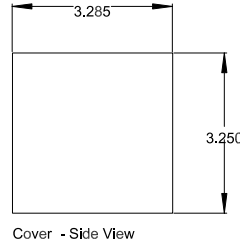
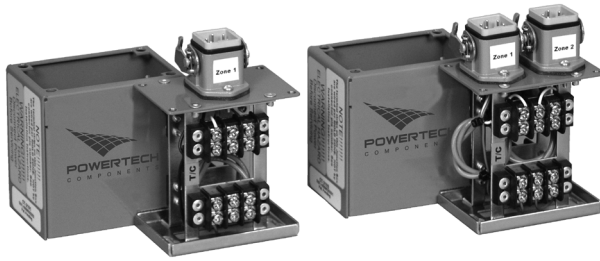

Mold Mounting Footprint

## 1 OR 2 ZONES (4-PIN CONNECTOR)

	ZONES	PART #
Combination Power & Thermocouple	1	CT-2101
Combination Power & Thermocouple	2	CT-2102

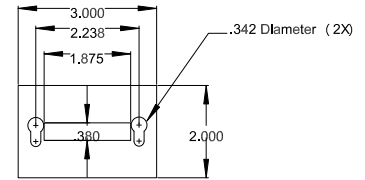
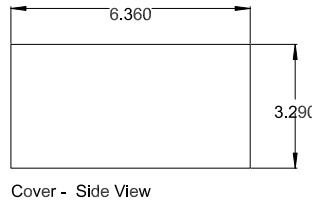
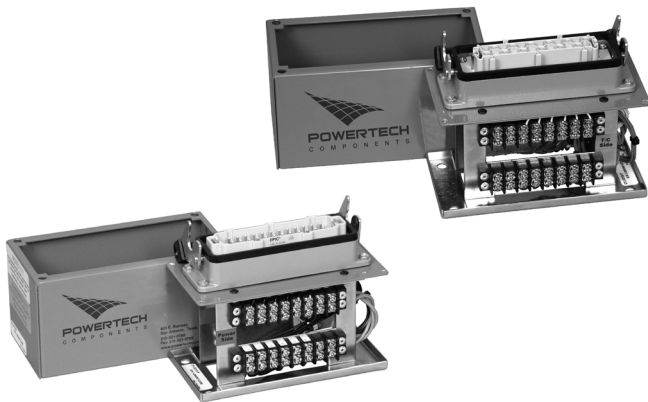

Mold Mounting Footprint

## 12-ZONE (OR LESS) 24-PIN CONNECTOR

	ZONES	CONNECTOR	SINGLE LATCH	DOUBLE LATCH
Thermocouple Only	12	24 HBE	CT-2212-T	CT-2212-T-D/L
Power Only	12	24 HBE	CT-2212-P	CT-2212-P-D/L
Combination Power/Thermocouple Cables	6	24 HBE	CT-2206	CT-2206-D/L

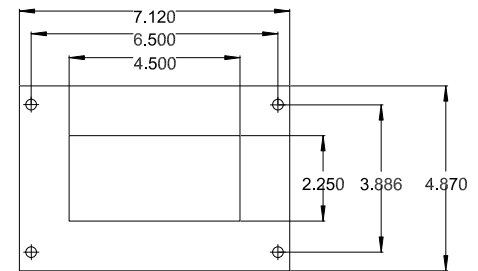
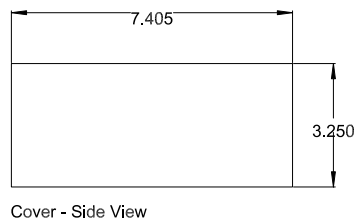
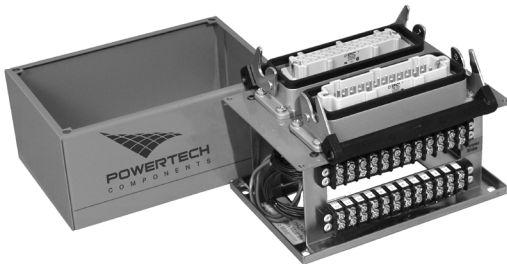

Mold Mounting Footprint

.282 Diameter (4X)

## SQUARE CONFIGURATION

	ZONES	CONNECTOR	SINGLE LATCH	DOUBLE LATCH
Combination Power/Thermocouple	12	24 HBE	CT-8712	CT-8712-D/L
Combination Power/Thermocouple	12	24 HBE	CT-8712-D	N/A
Combination Power/Thermocouple	8	16 HBE	CT-8708	CT-8708-D/L
Combination Power/Thermocouple	8	16 HBE	CT-8708-D	N/A

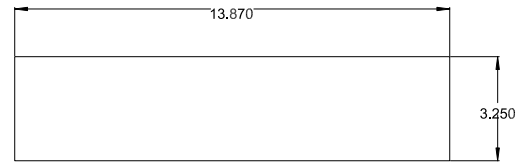
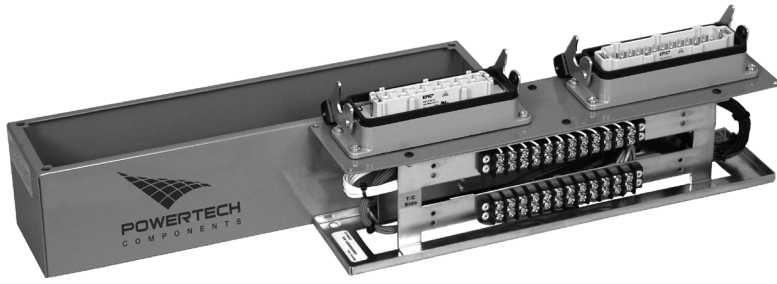

Cover - Side View

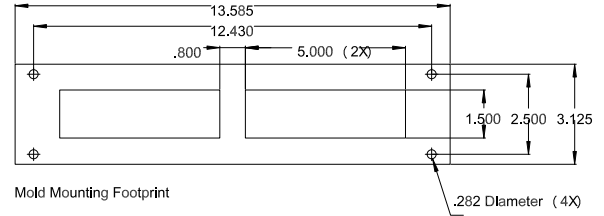

Mold Mounting Footprint

## RECTANGULAR CONFIGURATION

Combination Power/Thermocouple

ZONES	CONNECTOR	SINGLE LATCH	DOUBLE LATCH
12	24 HBE	CT-0412	CT-0412-D/L

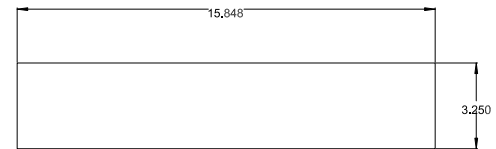
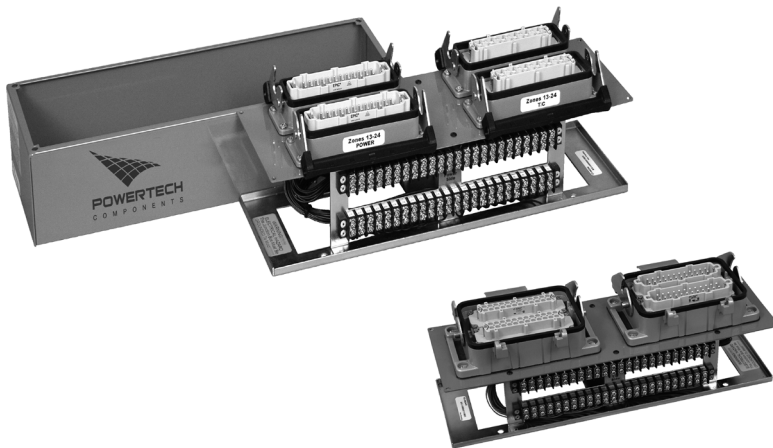

Cover - Side View

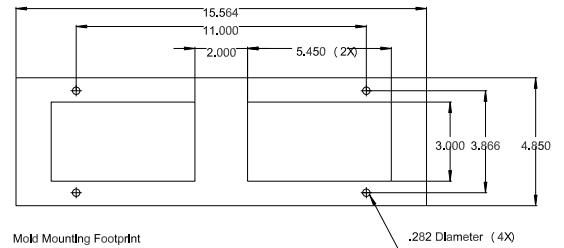

Mold Mounting Footprint

## 24 ZONES

Combination Power/Thermocouple  
 Combination Power/Thermocouple  
 Combination Power/Thermocouple

ZONES	CONNECTOR	SINGLE LATCH	DOUBLE LATCH
24	24 HBE	CT-06244	CT-06244-DL
16	16 HBE	N/A	CT-0616-D
16	16 HBE	CT-06164	CT-06164-DL

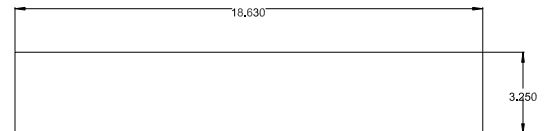
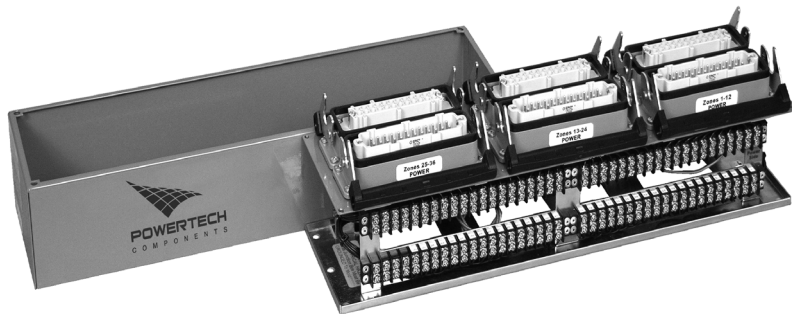

Cover - Side View

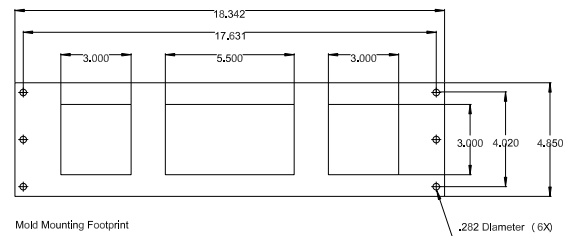

Mold Mounting Footprint

## 36 ZONES

Combination Power/Thermocouple

ZONES	CONNECTOR	SINGLE LATCH	DOUBLE LATCH
36	24 HBE	CT-0836-HBE	CX-0836-HBE

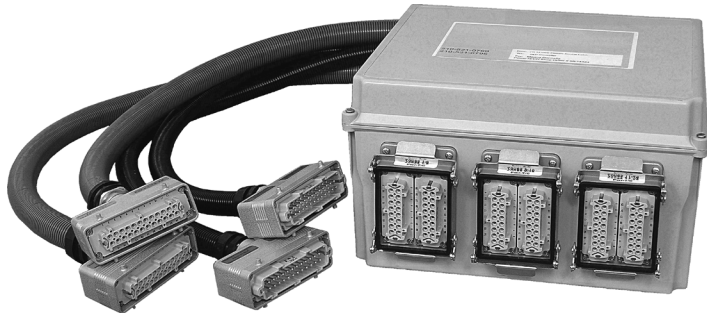

SPECIAL Transition System to Connect an INCOE® Mold with a 2-Tier Gammaflux® Controller

***Often the Connectors on a Mold are Completely Different from the Connectors on the Controller.***

**POWERTECH Manufactures Special Transition Systems and "Y" Cables for any configuration you can think of. All are Custom Engineered to your Specific Application with very Short Lead-Times.**



### TRANSITION CABLES FROM D-M-E® TYPE MOLD TO GAMMAFLUX®/MSI® CONTROLLER

	ZONES	PART #
Power Cable	12	CT-2012-15
Thermocouple Cable	12	CT-4012-15

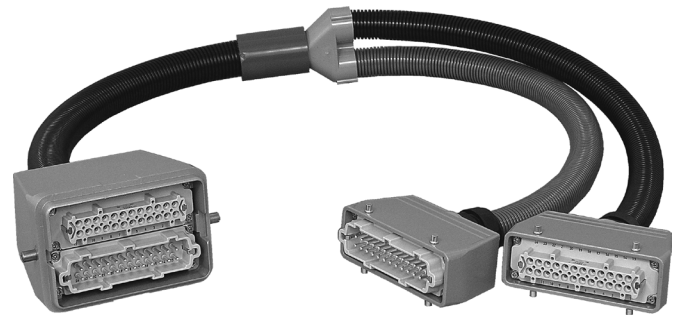

### SPECIAL "Y" CABLE TO CONNECT AN 2x24 HBE MOLD WITH A GAMMAFLUX®/MSI® CONTROLLER

	ZONES	PART #
Power Thermocouple Combination Cables	12	CY-2612-Y-15



### TRANSITION CABLES FROM EPIC® T TYPE MOLD TO D-M-E® TYPE CONTROLLER

	ZONES	PART #
Power Cable	12	CS-2112-15
Thermocouple Cable	12	CS-4112-15



### SPECIAL "Y" CABLE TO CONNECT AN 2x24 HBE MOLD WITH A D-M-E® TYPE CONTROLLER

	ZONES	PART #
Power Thermocouple Combination Cables	12	CY-2612-YD-15



From custom cables to custom transition wiring systems and special mounting requirements, POWERTECH has the answer. We can customize a solution for your specific application, no matter how complex it is.

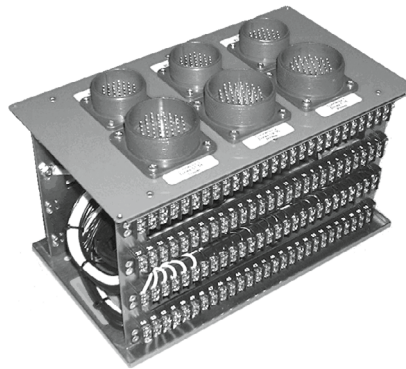

54-Zone System with Round Amphenol Military Style Connectors. The POWERTECH Terminal Block Wiring System is ideal for this type of soldered connection. The terminal blocks allow for easy servicing of the connectors without unsoldering.



Special Manifold Cable going from Japanese Nanaboshi connector to 6-HBS connector

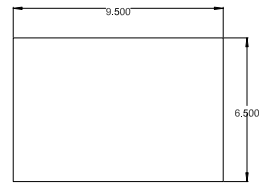

Cover - Side View

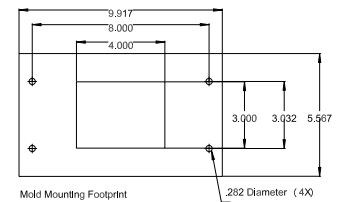

Mold Mounting Footprint

## Power FRAME Systems

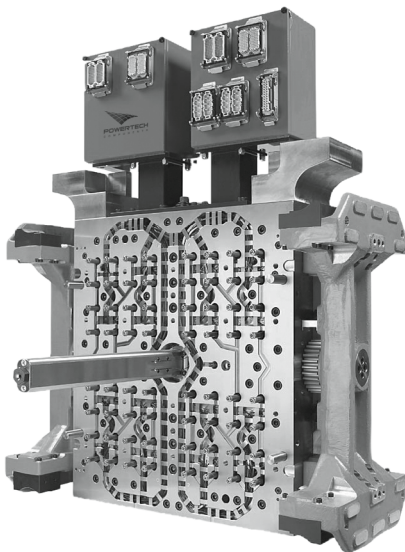

POWER FRAME SYSTEMS provide simple, efficient wiring solutions for Large Multi-Zone Hot Runner Systems.

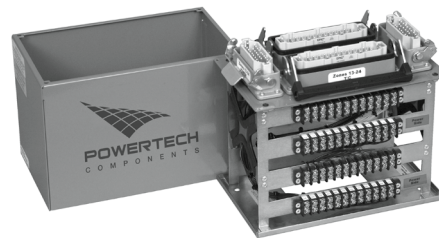

### COMPACT DME® TYPE - 24-ZONE

Power & Thermocouple Combination

**ZONES**                      **ITEM #**

24                                      CXX-0624-SHD

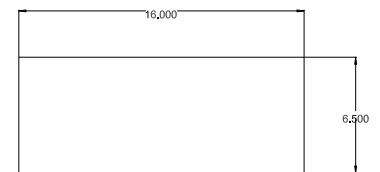

Cover - Side View

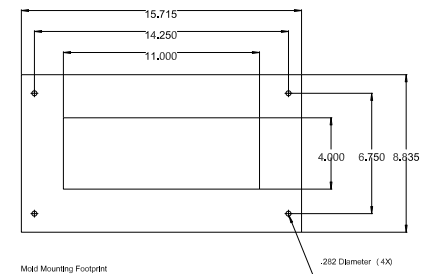

Mold Mounting Footprint

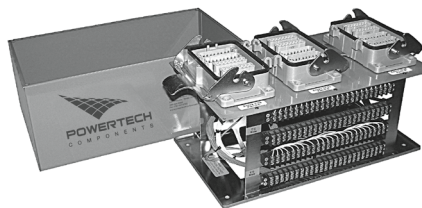

### HI-DENSITY 64 HA

Power & Thermocouple Combination

**ZONES**                      **ITEM #**

48                                      CX-0748-D

*Cables for this System are shown on Page 3*

## HA CONNECTORS

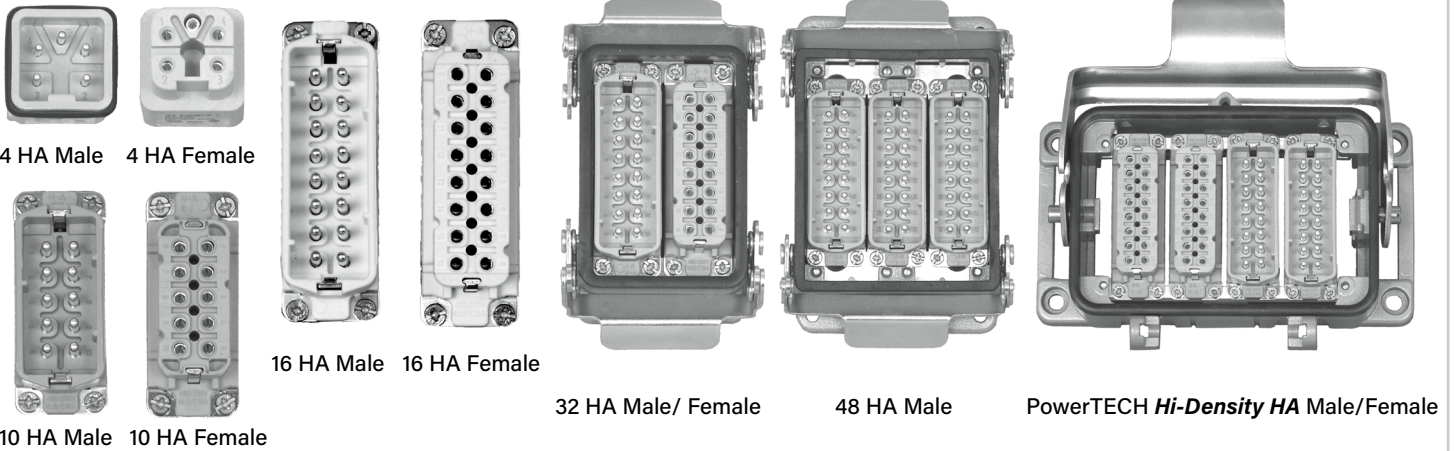

## HBE CONNECTORS

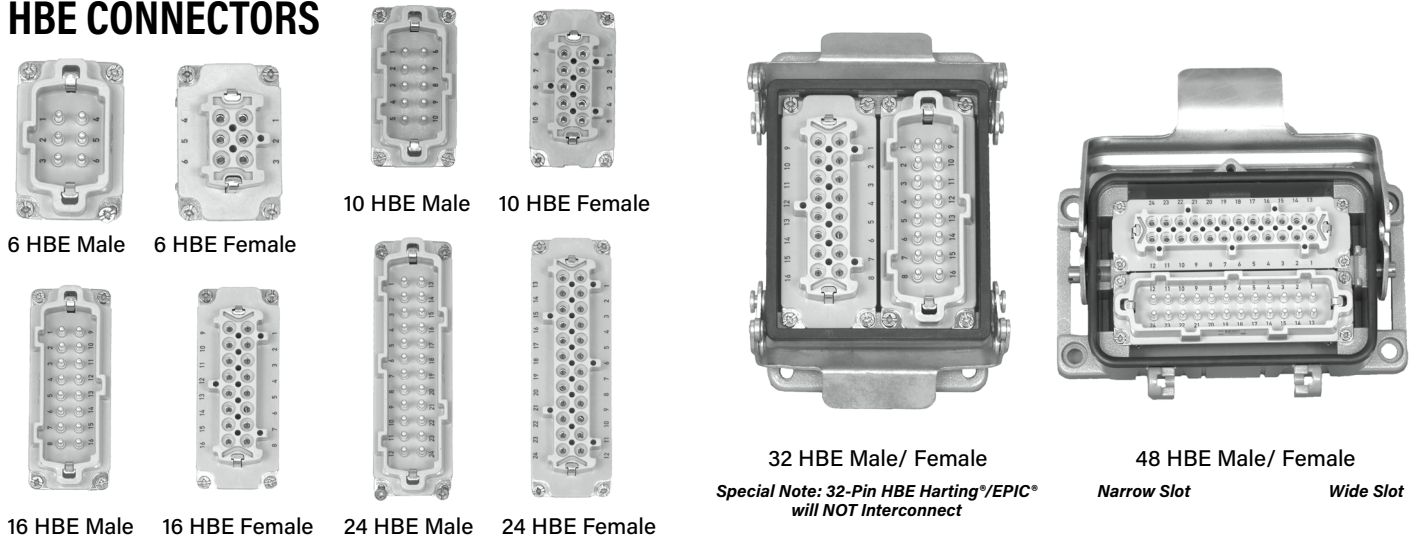

## HBS CONNECTORS

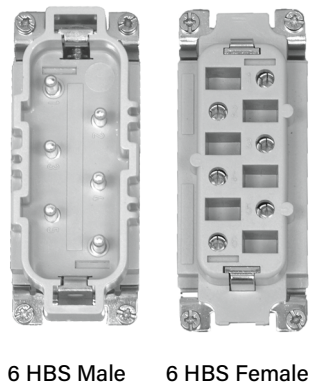

## SPECIAL CONNECTORS

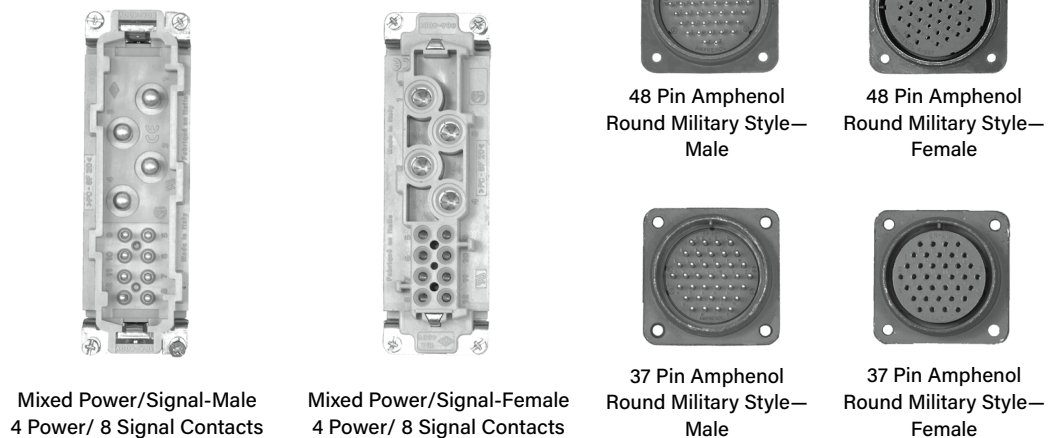

## HD CONNECTORS



25 HD Male



25 HD Female



40 HD Male

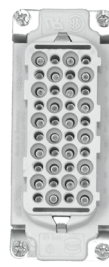

40 HD Female

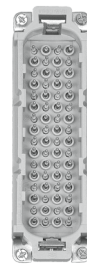

64 HD Male



64 HD Female

*All HD type Connectors from POWERTECH come with the Titan pin retention process STANDARD! NO PIN PUSH OUT! Guaranteed!*



## EE CONNECTORS

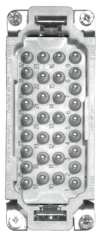

32 EE Male



32 EE Female



46 EE Male

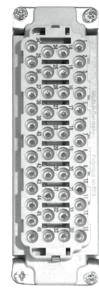

46 EE Female

## NANABOSHI CONNECTORS

Nanaboshi Male



Nanaboshi Female

## FITTINGS

Conduit Fitting



90° Conduit Fitting

## BASES & HOODS

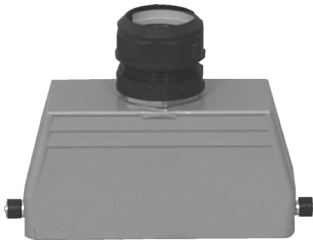

Single Latch Hood



Double-Latch Base

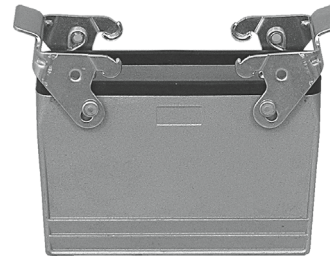

Cable Coupler Double Latch Hood

Cable Coupler Hoods are used to connect two cables together end to end.

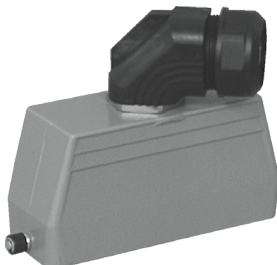

Single Latch Top Entry Hood with 90° Fitting

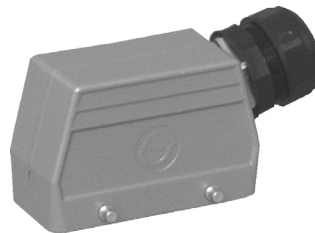

Double Latch Side Entry Hood

*Top Entry Hoods are Standard unless otherwise Specified. We will be happy to discuss the best solutions for your specific applications.*



The conduit fitting is sold separately from the hood.

***These are the most common connectors used in industry. If you don't see the connector you are looking for, please contact us directly. We handle a wide range of non-standard industry connectors.***

## CABLE REPAIR

Hot Runner cables are exposed to some of the roughest duty any cable can see and things can happen that take them out of service. Often they're thrown in a bin and forgotten about but there's a very good way to bring them back to life.

In addition to striving to manufacture the best Hot Runner Cables in the industry Powertech repairs and rebuilds cables no matter who built them. For almost 20 years Powertech has rebuilt cables manufactured by others and by watching what others have done, either right or wrong we've learned more and more how to make a better cable.

**First-** Each and every cable is thoroughly inspected at no charge to see what part of the cable is serviceable and what needs to be replaced.

**Second-** A quotation is prepared and sent to you for evaluation. When the cost to repair any cable exceeds 70% of the price of a new cable we will quote the new cable.

**Third-** Each Powertech repaired cable is provided with new Flexible, Industrial Grade Conduit and fittings. Damaged connectors and hoods are replaced. All wire is inspected for integrity and serviceability, each cable is carefully inspected and then Guaranteed as New for One Full Year.



## PLANT STANDARDIZATION SERVICES

POWERTECH will be happy to help you build a Plant Standardization program custom designed for your needs. Just give us call.

Standardizing of all Hot Runner Connections in a facility will reduce down-time and overall operating cost, allowing you to:

- Have the cable you need when you need it.
- Reduce the amount of cables needed.
- Reduce spare parts needed to keep all systems running.
- Allow maintenance personnel to become familiar with one connector type.

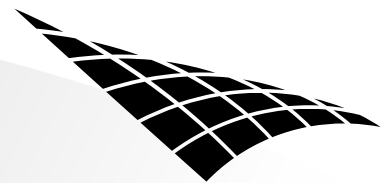
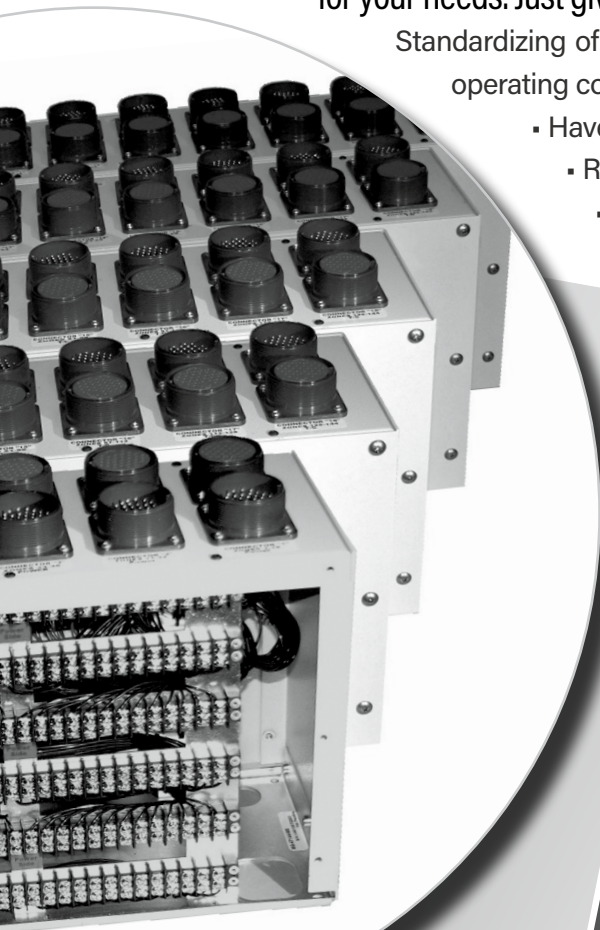

**POWERTECH**  
C O M P O N E N T S

**Distributed By:**

151 Memorial Drive, Unit H  
Shrewsbury, MA 01545  
Tel 888.792.2223  
sales@plastixs.com

**plastixs**<sup>®</sup>  
manufacturing solutions