



# A GUIDE TO HOT RUNNER CABLES & CONNECTORS

- **EPIC Industrial Connectors**
- **Mold Wiring Systems**
- **Power & Thermocouple Cables**

# TABLE OF CONTENTS

\*\*\*\*Each page has a  button in the upper left corner to bring you back to this page.\*\*\*\*

- [EPIC Industrial Connectors](#)
- [Mold Wiring Systems](#)
- [Power & Thermocouple Cables](#)

# EPIC® INDUSTRIAL CONNECTORS

For Hot Runner Controls, Molds, Robots, Machines, Accessories, Data, Etc.

## EPIC® HA 3/4 Series Housings, Hoods & Inserts

### Housings - Panel Mount

Part #	Description
PLX-10.4220	Plastic Housing
PLX-10.4225	Metal Housing

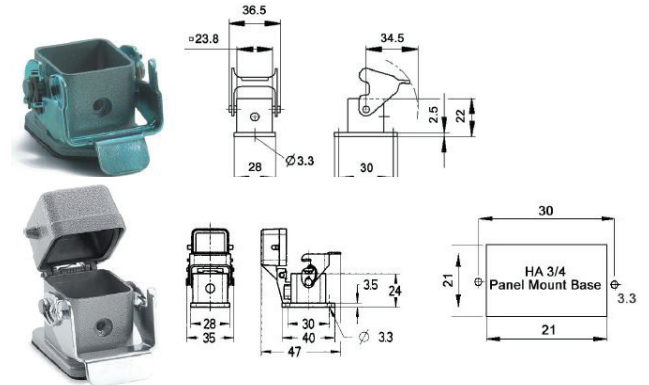

### Hoods (order Strain Relief Gland separately)

Part #	Description
PLX-10.4260	Plastic Hood, Top Entry
PLX-10.4270	Plastic Hood, Side Entry
PLX-10.5121	Metal Hood, Top Entry
PLX-10.5123	Metal Hood, Side Entry

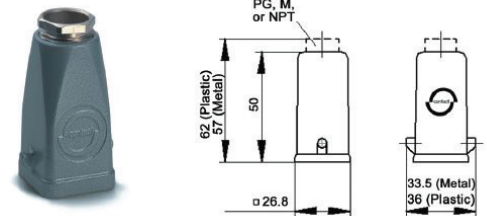

### Hoods - Cable to Cable (order Strain Relief Gland separately)

Part #	Description
PLX-10.4290	Plastic Hood, Top Entry
PLX-10.5129	Metal Hood, Top Entry

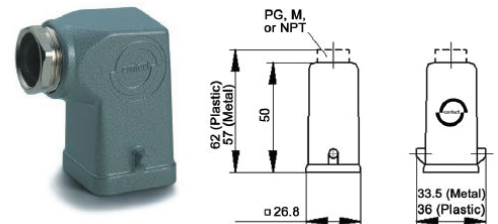

### SKINTOP® Straight Strain Relief Glands

Part #	Thread (M)	Wire O.D.
PLX-S1111	PG-11	0.157"-0.394"
PLX-S1211	PG-11	0.079"-0.276"

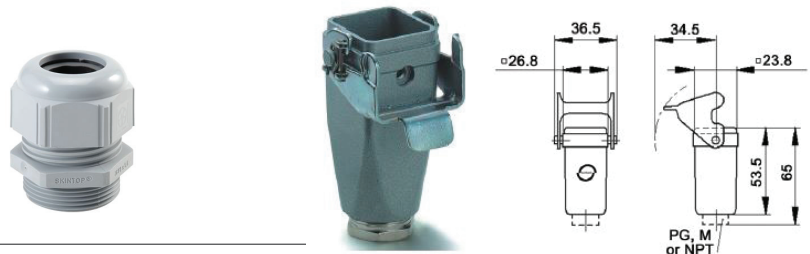

### EPIC® A Inserts (4 contacts + ⊕)

Part #	Description
PLX-10.4310	Plug Insert, Screw Terminated
PLX-10.4320	Receptacle Insert, Screw Terminated

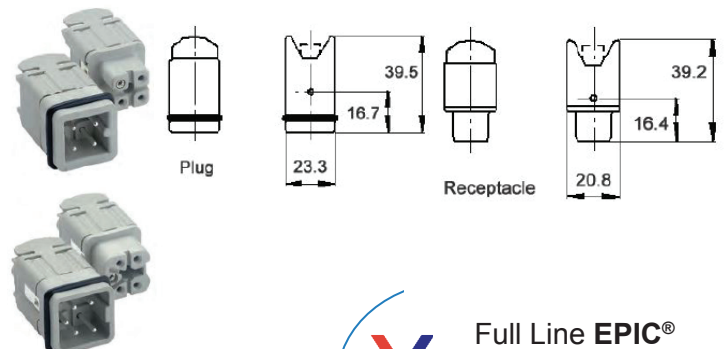

# EPIC® INDUSTRIAL CONNECTORS

For Hot Runner Controls, Molds, Robots, Machines, Accessories, Data, Etc.

[www.plastixs.com](http://www.plastixs.com)

## EPIC® HB 10 Series Housings, Hoods & Inserts

### Housings - Panel Mount

Part #	Description
PLX-10.0329	Metal Housing, Single Lever
PLX-10.0320	Metal Housing, Double Lever

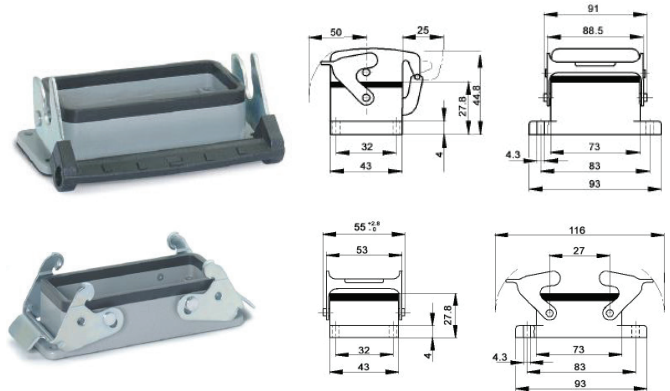

### Hoods (order Strain Relief Gland separately)

Part #	Description
PLX-10.0409	Top Entry, Single Lever
PLX-10.0400	Top Entry, Double Lever
PLX-10.0429	Side Entry, Single Lever
PLX-10.0420	Side Entry, Double Lever

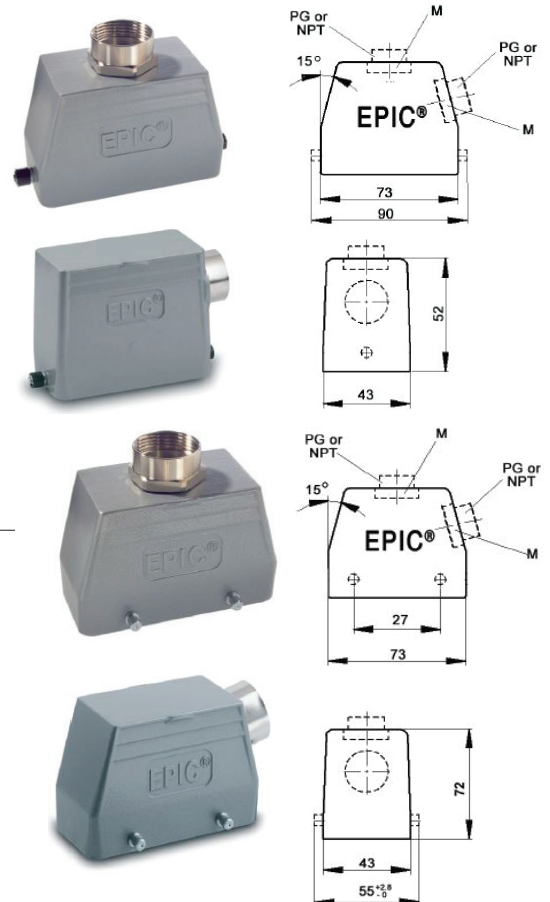

### SKINTOP® Straight Strain Relief Glands

Part #	Thread (M)	Wire O.D.
PLX-S1116	PG-16	0.354"-0.551"
PLX-S1216	PG-16	0.236"-0.472"



### EPIC® E Inserts (10 contacts + ⊕)

Part #	Description
PLX-10.1920	Plug Insert, Screw Terminated
PLX-10.1930	Receptacle Insert, Screw Terminated

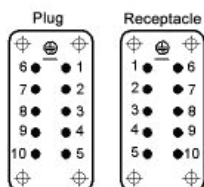

**Full Line EPIC®**  
 Industrial Connectors  
 Distributor  
 call us for part #'s not listed

# EPIC® INDUSTRIAL CONNECTORS

For Hot Runner Controls, Molds, Robots, Machines, Accessories, Data, Etc.

## EPIC® HA 16 Series Housings, Hoods & Inserts

### Housings - Panel Mount

Part #	Description
PLX-10.4620	Metal Housing, Single Lever

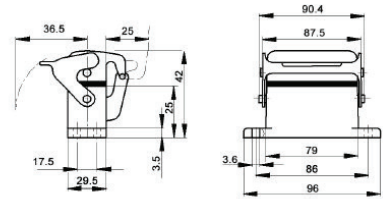

### Hoods (order Strain Relief Gland separately)

Part #	Description	Thread (M)
PLX-10.5650	Top Entry, Single Lever	PG-16
PLX-10.5652	Top Entry, Single Lever	PG-21
PLX-10.5640	Side Entry, Single Lever	PG-16
PLX-10.5645	Side Entry, Single Lever	PG-21

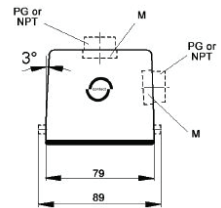
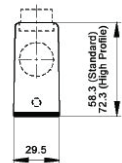

### SKINTOP® Straight Strain Relief Glands

Part #	Thread (M)	Wire O.D.
PLX-S1116	PG-16	0.354"-0.551"
PLX-S1121	PG-21	0.521"-0.709"



Full Line EPIC®  
Industrial Connectors  
Distributor  
call us for part #'s not listed

### EPIC® A Inserts (16 contacts + ⊕)

Part #	Description
PLX-10.5300	Plug Insert, Screw Terminated
PLX-10.5310	Receptacle Insert, Screw Terminated

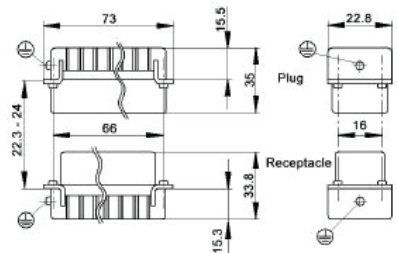

All dimensions are in mm.

### EPIC® D Inserts (25 contacts + ⊕)

Part #	Description
PLX-11.2833	Plug Insert, Screw Terminated
PLX-11.2823	Receptacle Insert, Screw Terminated

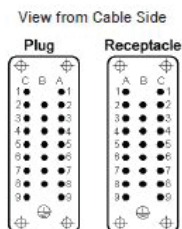

# EPIC® INDUSTRIAL CONNECTORS

For Hot Runner Controls, Molds, Robots, Machines, Accessories, Data, Etc.

[www.plastixs.com](http://www.plastixs.com)

## EPIC® HB 16 Series Housings, Hoods & Inserts

### Housings - Panel Mount

Part #	Description
PLX-10.0729	Metal Housing, Single Lever
PLX-10.0720	Metal Housing, Double Lever

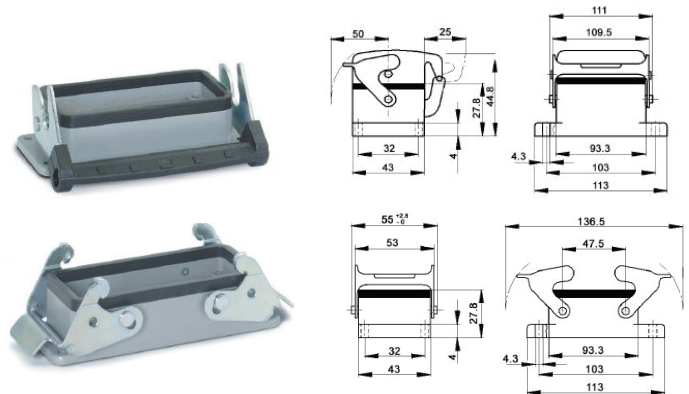

### Hoods (order Strain Relief Gland separately)

Part #	Description	Thread (M)
PLX-10.0809	Top Entry, Single Lever	PG-21
PLX-10.0800	Top Entry, Double Lever	PG-21
PLX-10.0829	Side Entry, Single Lever	PG-21
PLX-10.0820	Side Entry, Double Lever	PG-21
PLX-10.0909	Top Entry, Single Lever	PG-29
PLX-10.0900	Top Entry, Double Lever	PG-29

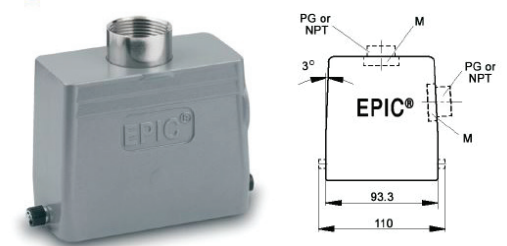

### SKINTOP® Straight Strain Relief Glands

Part #	Thread (M)	Wire O.D.
PLX-S1121	PG-21	0.521"-0.709"
PLX-S1221	PG-21	0.354"-0.630"

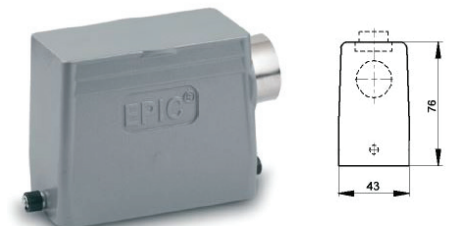

### EPIC® E Inserts (16 contacts + ⊕)

Part #	Description
PLX-10.1940	Plug Insert, Screw Terminated #1-16
PLX-10.1950	Receptacle Insert, Screw Terminated #1-16
PLX-10.2020	Plug Insert, Screw Terminated #17-32
PLX-10.2030	Receptacle Insert, Screw Terminated #17-32

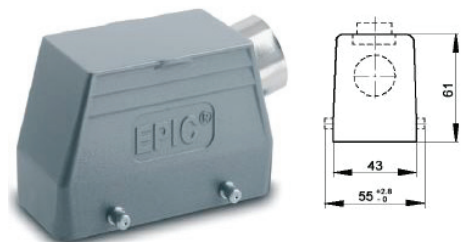
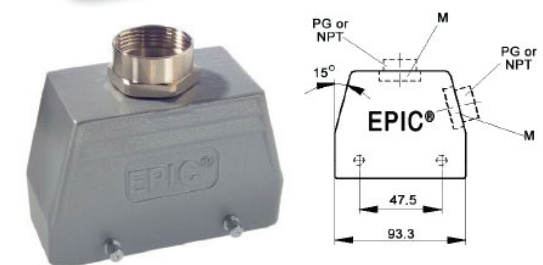
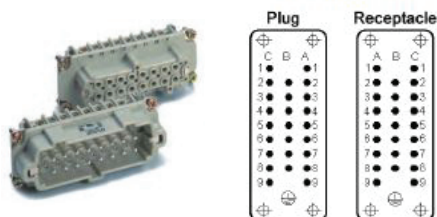

# EPIC® INDUSTRIAL CONNECTORS

For Hot Runner Controls, Molds, Robots, Machines, Accessories, Data, Etc.

[www.plastixs.com](http://www.plastixs.com)

## EPIC® HB 24 Series Housings, Hoods & Inserts

### Housings - Panel Mount

Part #	Description
PLX-10.1029	Metal Housing, Single Lever
PLX-10.1020	Metal Housing, Double Lever

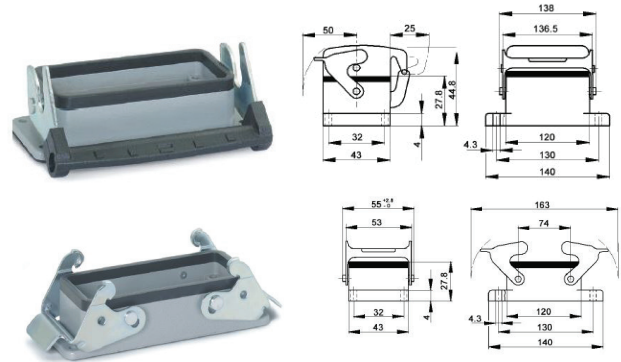

### Hoods (order Strain Relief Gland separately)

Part #	Description
PLX-10.1219	Top Entry, Single Lever
PLX-10.1139	Side Entry, Single Lever
PLX-10.1210	Top Entry, Double Lever
PLX-10.1130	Side Entry, Double Lever
PLX-10.1119	Top Entry, Single Lever
PLX-10.1239	Side Entry, Single Lever
PLX-10.1110	Top Entry, Double Lever
PLX-10.1230	Side Entry, Double Lever

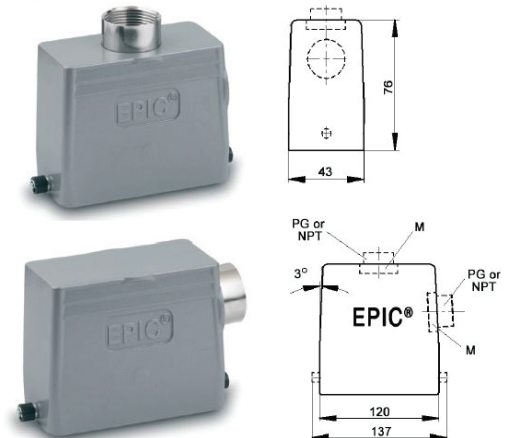

### SKINTOP® Straight Strain Relief Glands

Part #	Thread (M)	Wire O.D.
PLX-S1121	PG-21	0.521"-0.709"
PLX-S1221	PG-21	0.354"-0.630"
PLX-S1129	PG-29	0.551"-0.984"
PLX-S1229	PG-29	0.433"-0.787"

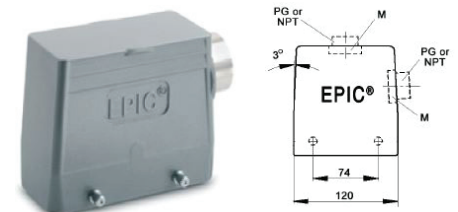
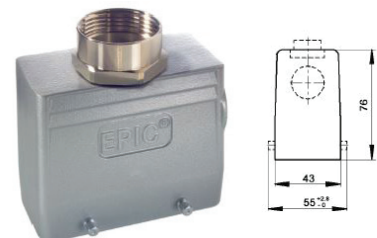

### EPIC® E Inserts (24 contacts + Ⓛ)

Part #	Description	Price
PLX-10.1960	Plug Insert, Screw Terminated #1-24	\$23.50
PLX-10.1970	Receptacle Insert, Screw Terminated #1-24	\$23.75

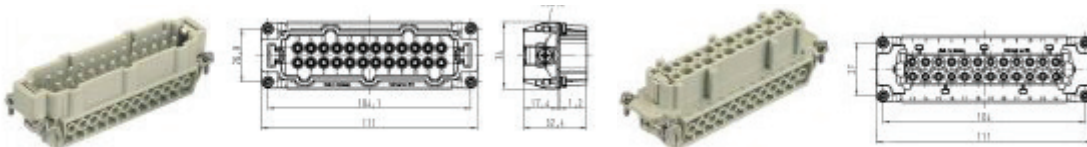

# EPIC® INDUSTRIAL CONNECTORS

For Hot Runner Controls, Molds, Robots, Machines, Accessories, Data, Etc.

[www.plastixs.com](http://www.plastixs.com)

## EPIC® HA 32 Series Housings, Hoods & Inserts



### Housings - Panel Mount

Part #	Description
PLX-10.4720	Metal Housing, Double Lever

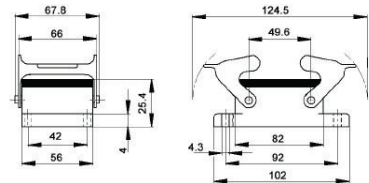

### Hoods (order Strain Relief Gland separately)

Part #	Description
PLX-10.5820	Top Entry, Double Lever
PLX-10.5760	Side Entry, Double Lever
PLX-10.5830	Top Entry, Double Lever
PLX-10.5770	Side Entry, Double Lever

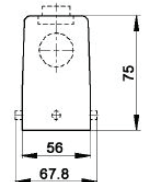

### SKINTOP® Straight Strain Relief Glands

Part #	Thread (M)	Wire O.D.
PLX-S1121	PG-21	0.521"-0.709"
PLX-S1129	PG-29	0.551"-0.984"

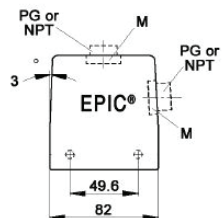

### EPIC® A Inserts (16 contacts + ⊕)

Part #	Description
PLX-10.5300	Plug Insert, Screw Terminated #1-16
PLX-10.5310	Receptacle Insert, Screw Terminated #1-16
PLX-10.5400	Plug Insert, Screw Terminated #17-32
PLX-10.5410	Receptacle Insert, Screw Terminated #17-32

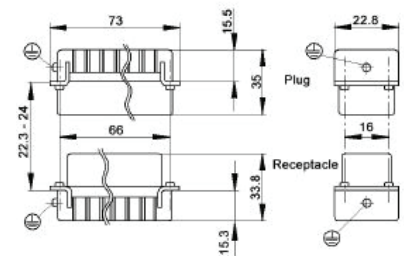

All dimensions are in mm.

### EPIC® D Inserts (25 contacts + ⊕)

Part #	Description
PLX-11.2833	Plug Insert, Crimp Terminated
PLX-11.2823	Receptacle Insert, Crimp Terminated



View from Cable Side

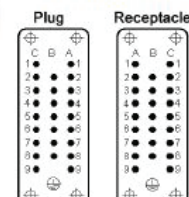



# EPIC® INDUSTRIAL CONNECTORS

For Hot Runner Controls, Molds, Robots, Machines, Accessories, Data, Etc.

[www.plastixs.com](http://www.plastixs.com)

## EPIC® HB 32 Series Housings, Hoods & Inserts

### Housings - Panel Mount

<u>Part #</u>	<u>Description</u>
PLX-10.1320	Metal Housing, Double Lever

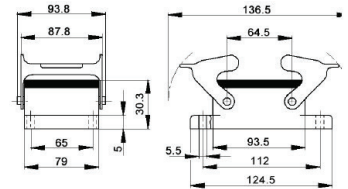

### Hoods (order Strain Relief Gland separately)

<u>Part #</u>	<u>Description</u>
PLX-10.1340	Top Entry, Double Lever
PLX-10.1360	Side Entry, Double Lever

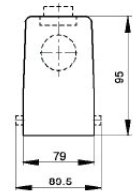

### SKINTOP® Straight Strain Relief Glands

<u>Part #</u>	<u>Thread (M)</u>	<u>Wire O.D.</u>
PLX-S1129	PG-29	0.521"-0.709"
PLX-S1229	PG-29	0.433"-0.787"
PLX-S1136	PG-36	0.945"-1.260"
PLX-S1236	PG-36	0.669"-1.024"

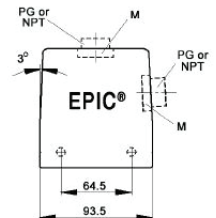

### EPIC® E Inserts (16 contacts + ⊥)

<u>Part #</u>	<u>Description</u>
PLX-10.1940	Plug Insert, Screw Terminated #1-16
PLX-10.1950	Receptacle Insert, Screw Terminated #1-16
PLX-10.2020	Plug Insert, Screw Terminated #17-32
PLX-10.2030	Receptacle Insert, Screw Terminated #17-32

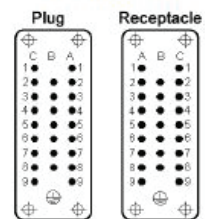

Full Line EPIC®  
Industrial Connectors  
Distributor

call us for part #'s not listed

# EPIC® INDUSTRIAL CONNECTORS

For Hot Runner Controls, Molds, Robots, Machines, Accessories, Data, Etc.

[www.plastixs.com](http://www.plastixs.com)

## EPIC® HB 48 Series Housings, Hoods & Inserts

### Housings - Panel Mount

Part #	Description
PLX-10.1610	Metal Housing, Single Lever
PLX-10.1520	Metal Housing, Single Lever w/cover

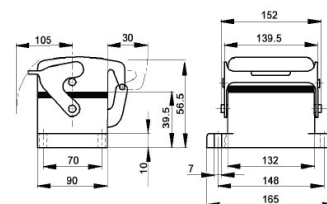

### Hoods (order Strain Relief Gland separately)

Part #	Description
PLX-10.1550	Top Entry, Single Lever
PLX-10.1580	Side Entry, Single Lever
PLX-10.1560	Top Entry, Single Lever
PLX-10.1590	Side Entry, Single Lever
PLX-10.1570	Top Entry, Single Lever
PLX-10.1600	Side Entry, Single Lever

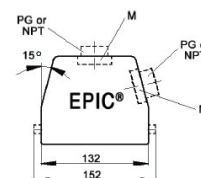
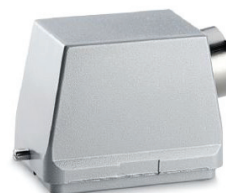
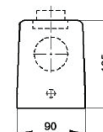

### SKINTOP® Straight Strain Relief Glands

Part #	Thread (M)	Wire O.D.
PLX-S1129	PG-29	0.521"-0.709"
PLX-S1229	PG-29	0.433"-0.787"
PLX-S1136	PG-36	0.945"-1.260"
PLX-S1236	PG-36	1.378"-1.496"
PLX-S1142	PG-42	0.669"-1.024"
PLX-S1242	PG-42	0.866"-1.220"



### EPIC® E Inserts (24 contacts + ⊕)

Part #	Description
PLX-10.1960	Plug Insert, Screw Terminated #1-24
PLX-10.1970	Receptacle Insert, Screw Terminated #1-24
PLX-10.2040	Plug Insert, Screw Terminated #25-48
PLX-10.2050	Receptacle Insert, Screw Terminated #25-48

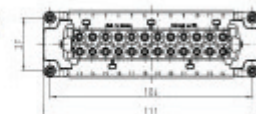
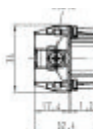
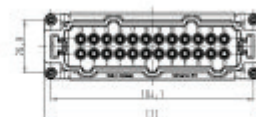

# Mold Wiring Systems

Hot Runner wiring systems and cables eliminate downtime due to mold wiring problems. All terminal blocks are numbered by mold zone, and the mold connectors are pre-wired to the correct terminal block position at the factory. Two standard styles are available, one for industry standard systems and one with HBE connectors (commonly used on HUSKY, Mold-Master, Gammaflux, MSI and other). Special configurations are available for any application up to 256 zones. Please call for pricing.

## Features and Benefits

- Gets mold up and running faster and keeps it running
- No crimping, no ferrules
- Reduces setup time
- Reduces costly breakdowns
- Simplifies troubleshooting



## For Industry Standard Systems

Model Number	Description	Price
CT-0812	12-zones (10.440 Long x 3.290 wide x 3.125 high)	*
CT-0808	8-zones (10.440 Long x 3.290 wide x 3.125 high)	*
CT-0805	5-zones (10.440 Long x 3.290 wide x 3.125 high)	*
CT-8712-DM	12-zones (7.405 Long x 5.035 wide x 3.125 high)	*
CT-8708-DM	8-zones (7.405 Long x 5.035 wide x 3.125 high)	*
CT-8705-DM	5-zones (7.405 Long x 5.035 wide x 3.125 high)	*
CT-0624-SHD	24-zones (15.848 Long x 5.015 wide x 3.125 high)	*
CT-0616-SHD	16-zones (15.848 Long x 5.015 wide x 3.125 high)	*

\*\*These systems are two, 12-zone Systems in one logical compact enclosure.  
The terminal blocks are wired 1-24

\* Please call for current pricing

## For HBE Type Systems

Model Number	Description	Price
CT-2206	6-zones (6.360 Long x 3.290 wide x 3.125 high)	*
CT-0412	12-zones (13.870 Long x 3.290 wide x 3.125 high)	*
CT-8712	12-zones (7.405 Long x 5.035 wide x 3.125 high) with 24-pin connector for power and 24-pin connector for thermocouple in two separate housings	*
CT-8712-D	12-zones (7.405 Long x 5.035 wide x 3.125 high) with 24-pin connector for power and 24-pin connector for thermocouple in one housing	*
CT-0624-D**	24-zones (15.848 Long x 5.015 wide x 3.125 high)	*
CT-0616-D**	16-zones (15.848 Long x 5.015 wide x 3.125 high)	*

\*\*These systems are two, 12-zone Systems in one logical compact enclosure.  
The terminal blocks are wired 1-24

\* Please call for current pricing

# POWER & THERMOCOUPLE CABLES

Eliminate pin push out in both the cable and mold connector using Titan Connections. All cables are clearly labeled for Mold End or Controller End and are color coded black for Power and gray for Thermocouple. Cables for stack molds, and special transition and "Y" cables also available.



## For Industry Standard Connectors

Model Number	Cable Type	Description	Price
CT-2512-10	Power	12-zones, 10 foot power cable	*
CT-2508-10	Power	8-zones, 10 foot power cable	*
CT-2505-10	Power	5-zones, 10 foot power cable	*
CT-2512-15	Power	12-zones, 15 foot power cable	*
CT-2508-15	Power	8-zones, 15 foot power cable	*
CT-2505-15	Power	5-zones, 15 foot power cable	*
CT-2512-20	Power	12-zones, 20 foot power cable	*
CT-2508-20	Power	8-zones, 20 foot power cable	*
CT-2505-20	Power	5-zones, 20 foot power cable	*
CT-4512-10	Thermocouple	12-zones, 10 foot thermocouple cable	*
CT-4508-10	Thermocouple	8-zones, 10 foot thermocouple cable	*
CT-4505-10	Thermocouple	5-zones, 10 foot thermocouple cable	*
CT-4512-15	Thermocouple	12-zones, 15 foot thermocouple cable	*
CT-4508-15	Thermocouple	8-zones, 15 foot thermocouple cable	*
CT-4505-15	Thermocouple	5-zones, 15 foot thermocouple cable	*
CT-4512-20	Thermocouple	12-zones, 20 foot thermocouple cable	*
CT-4508-20	Thermocouple	8-zones, 20 foot thermocouple cable	*
CT-4505-20	Thermocouple	5-zones, 20 foot thermocouple cable	*

\* Please call for current pricing

## For EPIC® Type Connectors

Model Number	Cable Type	Description	Price
CT-2412-10	Power	12-zones, 10 foot power cable	*
CT-2424-10	Power	24-zones, 10 foot power cable	*
CT-2412-15	Power	12-zones, 15 foot power cable	*
CT-2424-15	Power	24-zones, 15 foot power cable	*
CT-2412-20	Power	12-zones, 20 foot power cable	*
CT-2424-20	Power	24-zones, 20 foot power cable	*
CT-4412-10	Thermocouple	12-zones, 10 foot thermocouple cable	*
CT-4424-10	Thermocouple	24-zones, 10 foot thermocouple cable	*
CT-4412-15	Thermocouple	12-zones, 15 foot thermocouple cable	*
CT-4424-15	Thermocouple	24-zones, 15 foot thermocouple cable	*
CT-4412-20	Thermocouple	12-zones, 20 foot thermocouple cable	*
CT-4424-20	Thermocouple	24-zones, 20 foot thermocouple cable	*
CT-2606-10	Power/Thermocouple	6-zones, 10 foot combination cable	*
CT-2612-10	Power/Thermocouple	12-zones, 10 foot combination cable	*
CT-2606-15	Power/Thermocouple	6-zones, 15 foot combination cable	*
CT-2612-15	Power/Thermocouple	12-zones, 15 foot combination cable	*
CT-2606-20	Power/Thermocouple	6-zones, 20 foot combination cable	*
CT-2612-20	Power/Thermocouple	12-zones, 20 foot combination cable	*

\* Please call for current pricing