

PE5 Ejector Sleeves

Nitrided Ejector Sleeves - Standard Inch

Features

- Material: H-13 Hotwork Die Steel
- Nitrided OD and ID 65 - 74 Rc



Description

Plastixs® PE5 Nitrided Ejector Sleeves are made from the finest grade, premium H-13 hotwork die steel. The heads are hot forged and stress relieved for uniform grain flow and high tensile strength.

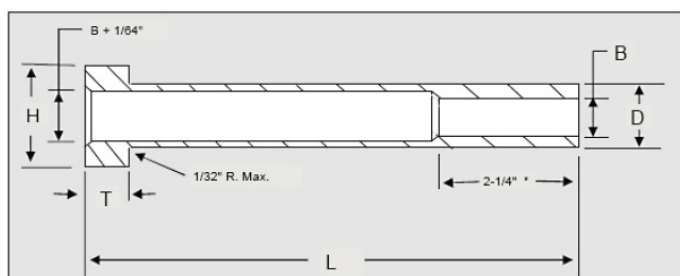

TOLERANCES				
I.D.	O.D.	Head Diameter	Head Thickness	OAL
B	D	H	T	L
+0.0005"	-0.0003"	+0.000"	+0.000"	+0.125"
-0.0000"	-0.0008"	-0.010"	-0.002"	-0.000"

B	D	H	T	L = 3"	L = 4"	L = 5"	L = 6"	L = 7"
I.D.	O.D.	Head Diameter	Head Thickness	Item#	Item#	Item#	Item#	Item#
3/32"	3/16"	3/8"	3/16"	PE5-094L3	PE5-094L4	PE5-094L5	PE5-094L6	PE5-094L7
1/8"	7/32"	13/32"	3/16"	PE5-125L3	PE5-125L4	PE5-125L5	PE5-125L6	PE5-125L7
5/32"	1/4"	7/16"	3/16"	-	PE5-156L4	PE5-156L5	PE5-156L6	PE5-156L7
3/16"	5/16"	1/2"	1/4"	-	PE5-187L4	PE5-187L5	PE5-187L6	PE5-187L7
7/32"	11/32"	9/16"	1/4"	-	PE5-219L4	PE5-219L5	PE5-219L6	PE5-219L7
1/4"	3/8"	5/8"	1/4"	-	PE5-250L4	PE5-250L5	PE5-250L6	PE5-250L7
5/16"	7/16"	11/16"	1/4"	-	PE5-312L4	PE5-312L5	PE5-312L6	PE5-312L7
3/8"	1/2"	3/4"	1/4"	-	PE5-375L4	PE5-375L5	PE5-375L6	PE5-375L7
7/16"	5/8"	7/8"	1/4"	-	PE5-437L4	PE5-437L5	PE5-437L6	PE5-437L7
1/2"	11/16"	15/16"	1/4"	-	PE5-500L4	PE5-500L5	PE5-500L6	PE5-500L7
9/16"	3/4"	1"	1/4"	-	PE5-562L4	PE5-562L5	PE5-562L6	PE5-562L7
5/8"	7/8"	1-1/8"	1/4"	-	PE5-625L4	PE5-625L5	PE5-625L6	PE5-625L7
3/4"	1"	1-1/4"	1/4"	-	PE5-750L4	PE5-750L5	PE5-750L6	PE5-750L7



PE5 Ejector Sleeves (Continued)

Nitrided Ejector Sleeves - Standard Inch

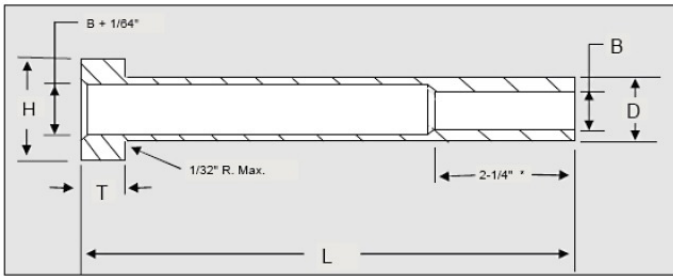

TOLERANCES				
I.D.	O.D.	Head Diameter	Head Thickness	OAL
B	D	H	T	L
+0.0005"	-0.0003"	+0.000"	+0.000"	+0.125"
-0.0000"	-0.0008"	-0.010"	-0.002"	-0.000"

B	D	H	T	L = 8"	L = 9"	L = 10"	L = 11"	L = 12"
I.D.	O.D.	Head Diameter	Head Thickness	Item#	Item#	Item#	Item#	Item#
3/32"	3/16"	3/8"	3/16"	PE5-094L8	PE5-094L9	PE5-094L10	PE5-094L11	PE5-094L12
1/8"	7/32"	13/32"	3/16"	PE5-125L8	PE5-125L9	PE5-125L10	PE5-125L11	PE5-125L12
5/32"	1/4"	7/16"	3/16"	PE5-156L8	PE5-156L9	PE5-156L10	PE5-156L11	PE5-156L12
3/16"	5/16"	1/2"	1/4"	PE5-187L8	PE5-187L9	PE5-187L10	PE5-187L11	PE5-187L12
7/32"	11/32"	9/16"	1/4"	PE5-219L8	PE5-219L9	PE5-219L10	PE5-219L11	PE5-219L12
1/4"	3/8"	5/8"	1/4"	PE5-250L8	PE5-250L9	PE5-250L10	PE5-250L11	PE5-250L12
5/16"	7/16"	11/16"	1/4"	PE5-312L8	PE5-312L9	PE5-312L10	PE5-312L11	PE5-312L12
3/8"	1/2"	3/4"	1/4"	PE5-375L8	PE5-375L9	PE5-375L10	PE5-375L11	PE5-375L12
7/16"	5/8"	7/8"	1/4"	PE5-437L8	PE5-437L9	PE5-437L10	PE5-437L11	PE5-437L12
1/2"	11/16"	15/16"	1/4"	PE5-500L8	PE5-500L9	PE5-500L10	PE5-500L11	PE5-500L12
9/16"	3/4"	1"	1/4"	PE5-562L8	PE5-562L9	PE5-562L10	PE5-562L11	PE5-562L12
5/8"	7/8"	1-1/8"	1/4"	PE5-625L8	PE5-625L9	PE5-625L10	PE5-625L11	PE5-625L12
3/4"	1"	1-1/4"	1/4"	PE5-750L8	PE5-750L9	PE5-750L10	PE5-750L11	PE5-750L12

