

PE7 Metric Ejector Pins

Nitrided Straight Metric Ejector Pins - DIN

Features

- Material: H-13 Hotwork Die Steel (1.2344)
- Core: Hardened Throughout to 41 - 45 Rc
- Surface: Ion Nitrided to 65 - 74 Rc



Description

Plastixs® PE7 Nitrided Straight Metric Ejector Pins are made from the finest grade, premium H-13 hotwork die steel. The heads are hot forged and stress relieved for uniform grain flow and high tensile strength.

Head Diameter H	Head Thickness T	OAL L
+0.0 mm -0.2 mm	+0.00 mm -0.05 mm	+2.0 mm -0.0 mm

TOLERANCES		
Pin DIA. (D) g6		R
Size	Tolerance	
0 to 3 mm	-.002 mm -.008 mm	0.3 mm
3.5 to 6 mm	-.002 mm -.008 mm	0.3 mm
6.5 to 10 mm	-.002 mm -.008 mm	0.5 mm
11 to 18 mm	-.006 mm -.017 mm	0.8 mm
20 to 25 mm	-.006 mm -.017 mm	0.8 mm

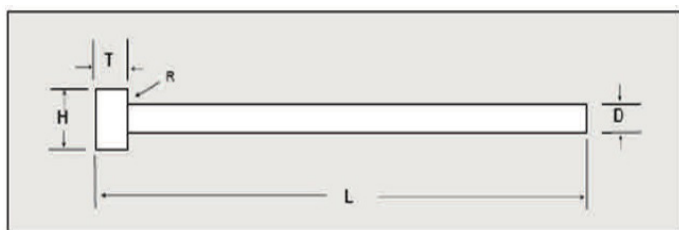

D		H Head Diameter	T Head Thickness	L-160 Item#	L-250 Item#	L-315 Item#	L-400 Item#	L-500 Item#
Pin Diameter								
Nominal Size	Inch Conversion							
2mm	0.0787"	4mm	2mm	PE7-02L160	PE7-02L250	-	-	-
2.5mm	0.0984"	5mm	2mm	PE7-025L160	PE7-025L250	PE7-025L315	-	-
3mm	0.1181"	6mm	3mm	PE7-03L160	PE7-03L250	PE7-03L315	PE7-03L400	PE7-03L500
3.5mm	0.1378"	7mm	3mm	PE7-035L160	PE7-035L250	PE7-035L315	PE7-035L400	PE7-035L500



PE7 Metric Ejector Pins (Continued)

Nitrided Straight Metric Ejector Pins - DIN

Head Diameter H	Head Thickness T	OAL L
+0.0 mm -0.2 mm	+0.00 mm -0.05 mm	+2.0 mm -0.0 mm

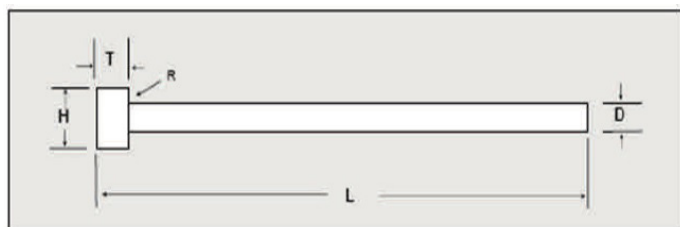

TOLERANCES		
Pin DIA. (D) g6		R
Size	Tolerance	
0 to 3 mm	-.002 mm -.008 mm	0.3 mm
3.5 to 6 mm	-.002 mm -.008 mm	0.3 mm
6.5 to 10 mm	-.002 mm -.008 mm	0.5 mm
11 to 18 mm	-.006 mm -.017 mm	0.8 mm
20 to 25 mm	-.006 mm -.017 mm	0.8 mm

D Pin Diameter		H Head Diameter	T Head Thickness	L-160 Item#	L-250 Item#	L-315 Item#	L-400 Item#	L-500 Item#
Nominal Size	Inch Conversion							
4mm	0.1575"	8mm	3mm	PE7-04L160	PE7-04L250	PE7-04L315	PE7-04L400	PE7-04L500
4.5mm	0.1772"	8mm	3mm	PE7-045L160	PE7-045L250	PE7-045L315	PE7-045L400	PE7-045L500
5mm	0.1969"	10mm	3mm	PE7-05L160	PE7-05L250	PE7-05L315	PE7-05L400	PE7-05L500
5.5mm	0.2165"	10mm	3mm	PE7-055L160	PE7-055L250	PE7-055L315	PE7-055L400	PE7-055L500
6mm	0.2362"	12mm	5mm	PE7-06L160	PE7-06L250	PE7-06L315	PE7-06L400	PE7-06L500
6.5mm	0.2559"	12mm	5mm	PE7-065L160	PE7-065L250	PE7-065L315	PE7-065L400	PE7-065L500
7mm	0.2756"	12mm	5mm	PE7-07L160	PE7-07L250	PE7-07L315	PE7-07L400	PE7-07L500
8mm	0.3150"	14mm	5mm	PE7-08L160	PE7-08L250	PE7-08L315	PE7-08L400	PE7-08L500
9mm	0.3543"	14mm	5mm	PE7-09L160	PE7-09L250	PE7-09L315	PE7-09L400	PE7-09L500
10mm	0.3937"	16mm	5mm	PE7-10L160	PE7-10L250	PE7-10L315	PE7-10L400	PE7-10L500
11mm	0.4331"	16mm	5mm	PE7-11L160	PE7-11L250	PE7-11L315	PE7-11L400	PE7-11L500
12mm	0.4724"	20mm	7mm	PE7-12L160	PE7-12L250	PE7-12L315	PE7-12L400	PE7-12L500
14mm	0.5512"	22mm	7mm	PE7-14L160	PE7-14L250	PE7-14L315	PE7-14L400	-
16mm	0.6299"	22mm	7mm	PE7-16L160	PE7-16L250	PE7-16L315	PE7-16L400	-
18mm	0.7087"	26mm	7mm	PE7-18L160	PE7-18L250	PE7-18L315	PE7-18L400	-
20mm	0.7874"	26mm	8mm	PE7-20L160	PE7-20L250	PE7-20L315	PE7-20L400	-
25mm	0.9843"	32mm	10mm	PE7-25L160	PE7-25L250	PE7-25L315	PE7-25L400	-

