

Single-Type Repair Clamp

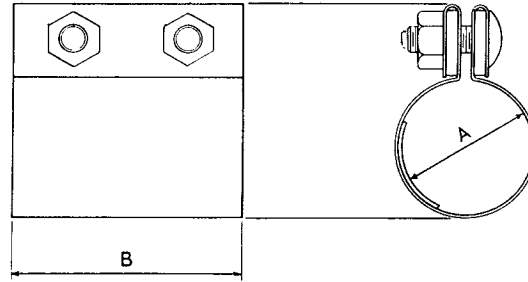
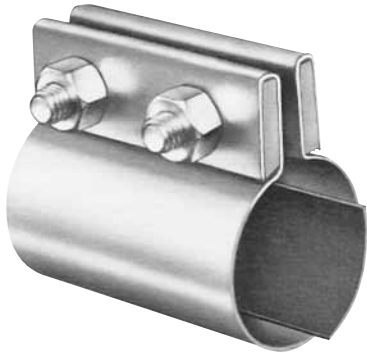

The Morris Single-Type Repair Clamp is suitable for the quick repair of minor leaks in all types of pipe. It consists of an outer shell of zinc-plated steel, together with a single-strip neoprene gasket. When other than steel clamps and neoprene gaskets are required, specifications should be stated on special order. Prices on other than stock sizes are available on request.

Nominal Pipe Size (I.P.S.)	O.D. of Pipe (A) (in.)	Morris Clamp Code No.	Clamp Length (B)	No. of Bolts	Size of Bolts	Weight (lbs.)	BLACK Gasket*
							PIC No.
1/2"	.840	1/2-2S	2"	2	5/16 x 1-1/4	.41	2000842B0
3/4"	1.050	3/4-2S	2"	2	5/16 x 1-1/4	.45	2001051B0
1"	1.315	1-1S	2"	1	1/2 x 1-3/4	.62	2001311B0
	1.315	1-2S	4"	2	1/2 x 1-3/4	1.2	2001312B0
1-1/4"	1.660	1-1/4-1S	2"	1	1/2 x 1-3/4	.75	2001661B0
	1.660	1-1/4-2S	4"	2	1/2 x 1-3/4	1.5	2001662B0
1-1/2"	1.900	1-1/2-1S	2"	1	1/2 x 1-3/4	.83	2001901B0
	1.900	1-1/2-2S	4"	2	1/2 x 1-3/4	1.6	2001902B0
2"	2.375	2-1S	2"	1	1/2 x 1-3/4	1.3	2002371B0
	2.375	2-2S	4"	2	1/2 x 1-3/4	2.2	2002372B0
	2.375	2-3S	6"	3	1/2 x 1-3/4	3.0	2002373B0
	2.375	2-4S	8"	4	1/2 x 1-3/4	4.1	2002374B0
2-1/2"	2.875	2-1/2-1S	2"	1	1/2 x 1-3/4	1.5	2002871B0
	2.875	2-1/2-2S	4"	2	1/2 x 1-3/4	2.3	2002872B0
	2.875	2-1/2-3S	6"	3	1/2 x 1-3/4	3.2	2002873B0
	2.875	2-1/2-4S	8"	4	1/2 x 1-3/4	4.4	2002874B0
3"	3.500	3-1S	2"	1	5/8 x 2	1.6	2003501B0
	3.500	3-2S	4"	2	5/8 x 2	2.5	2003502B0
	3.500	3-3S	6"	3	5/8 x 2	3.3	2003503B0
	3.500	3-4S	8"	4	5/8 x 2	4.6	2003504B0
3-1/2"	4.000	3-1/2-2S	4"	2	5/8 x 2	2.7	2004002B0
	4.000	3-1/2-3S	6"	3	5/8 x 2	3.5	2004003B0
	4.000	3-1/2-4S	8"	4	5/8 x 2	4.8	2004004B0
4"	4.500	4-2S	4"	2	5/8 x 2	2.9	2004502B0
	4.500	4-3S	6"	3	5/8 x 2	3.9	2004503B0
	4.500	4-4S	8"	4	5/8 x 2	5.1	2004504B0
5"	5.563	5-2S	4"	2	5/8 x 2	3.1	2005562B0
	5.563	5-3S	6"	3	5/8 x 2	4.2	2005563B0
	5.563	5-4S	8"	4	5/8 x 2	5.5	2005564B0
6"	6.625	6-2S	4"	2	5/8 x 2	3.4	2006622B0
	6.625	6-3S	6"	3	5/8 x 2	4.9	2006623B0
	6.625	6-4S	8"	4	5/8 x 2	6.4	2006624B0
8"	8.625	8-2S	6"	2	3/4 x 3	6.7	2008622B0
	8.625	8-3S	8"	3	3/4 x 3	9.6	2008623B0
	8.625	8-4S	10"	4	3/4 x 3	11.2	2008624B0
	8.625	8-5S	12"	5	3/4 x 3	13.6	2008625B0
10"	10.750	10-2S	6"	2	3/4 x 3	7.2	2010752B0
	10.750	10-3S	8"	3	3/4 x 3	10.7	2010753B0
	10.750	10-4S	10"	4	3/4 x 3	14.1	2010754B0
	10.750	10-5S	12"	5	3/4 x 3	17.9	2010755B0
12"	12.750	12-2S	6"	2	3/4 x 3	8.1	2012752B0
	12.750	12-3S	8"	3	3/4 x 3	11.6	2012753B0
	12.750	12-4S	10"	4	3/4 x 3	15.0	2012754B0
	12.750	12-5S	12"	5	3/4 x 3	18.8	2012755B0
14"	14.000	14-2S	6"	2	3/4 x 3	9.0	2014002B0
	14.000	14-3S	8"	3	3/4 x 3	12.5	2014003B0
	14.000	14-4S	10"	4	3/4 x 3	15.9	2014004B0
	14.000	14-5S	12"	5	3/4 x 3	19.7	2014005B0

All shipments F.O.B. Erie, PA

Prices subject to change without notice.

*Neoprene

Double-Type Repair Clamp

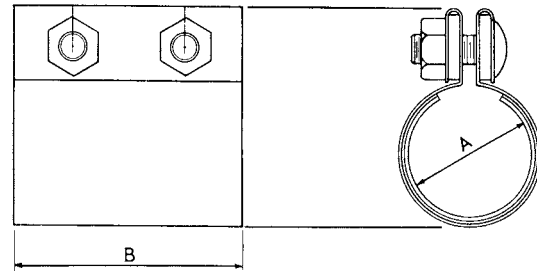
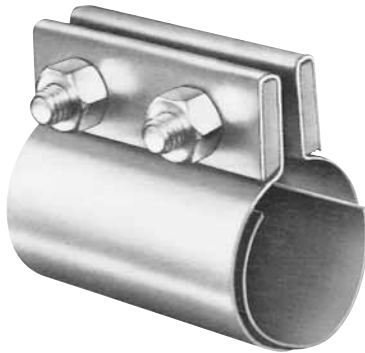

The **Morris Double-Type Repair Clamp** is suitable for use on all classifications of piping repair work. It contains an inner sleeve as well as a gasket that covers two-thirds of the circumference of the pipe; may be used individually or in series.

Shell and sleeve are of heavy, zinc-plated steel – gasket is black neoprene. Other materials available on special order. Request prices on sizes not listed.

Nominal Pipe Size (I.P.S.)	O.D. of Pipe (A) (in.)	Morris Clamp Code No.	Clamp Length (B)	No. of Bolts	Size of Bolts	Weight (lbs.)	BLACK Gasket*
							PIC No.
1/2"	.840	1/2-2D	2"	2	5/16 x 1-1/4	.5	2100842B0
3/4"	1.050	3/4-2D	2"	2	5/16 x 1-1/4	.54	2101052B0
1"	1.315	1-2D	4"	2	1/2 x 1-3/4	1.6	2101312B0
1-1/4"	1.600	1-1/4-2D	4"	2	1/2 x 1-3/4	1.7	2101602B0
1-1/2"	1.900	1-1/2-2D	4"	2	1/2 x 1-3/4	1.8	2101902B0
2"	2.375	2-2D	4"	2	1/2 x 1-3/4	2.3	2102372B0
	2.375	2-3D	6"	3	1/2 x 1-3/4	3.3	2102373B0
	2.375	2-4D	8"	4	1/2 x 1-3/4	4.6	2102374B0
2-1/2"	2.875	2-1/2-2D	4"	2	1/2 x 1-3/4	3.6	2102872B0
	2.875	2-1/2-3D	6"	3	1/2 x 1-3/4	3.8	2102873B0
	2.875	2-1/2-4D	8"	4	1/2 x 1-3/4	5.0	2102874B0
3"	3.500	3-2D	4"	2	5/8 x 2	2.9	2103502B0
	3.500	3-3D	6"	3	5/8 x 2	4.2	2103503B0
	3.500	3-4D	8"	4	5/8 x 2	5.6	2103504B0
3-1/2"	4.000	3-1/2-2D	4"	2	5/8 x 2	3.2	2104002B0
	4.000	3-1/2-3D	6"	3	5/8 x 2	4.5	2104003B0
	4.000	3-1/2-4D	8"	4	5/8 x 2	5.9	2104004B0
4"	4.500	4-2D	4"	2	5/8 x 2	3.5	2104502B0
	4.500	4-3D	6"	3	5/8 x 2	4.8	2104503B0
	4.500	4-4D	8"	4	5/8 x 2	6.1	2104504B0
4-1/2"	5.000	4-1/2-2D	4"	2	5/8 x 2	3.8	2105002B0
	5.000	4-1/2-3D	6"	3	5/8 x 2	5.1	2105003B0
	5.000	4-1/2-4D	8"	4	5/8 x 2	6.3	2105004B0
5"	5.563	5-2D	4"	2	5/8 x 2	4.1	2105562B0
	5.563	5-3D	6"	3	5/8 x 2	5.4	2105563B0
	5.563	5-4D	8"	4	5/8 x 2	6.5	2105564B0
6"	6.625	6-2D	4"	2	5/8 x 2	4.7	2106622B0
	6.625	6-3D	6"	3	5/8 x 2	6.0	2106623B0
	6.625	6-4D	8"	4	5/8 x 2	7.1	2106624B0
	6.625	6-5D	10"	5	5/8 x 2	8.3	2106625B0
8"	8.625	8-2D	6"	2	3/4 x 3	8.8	2108622B0
	8.625	8-3D	8"	3	3/4 x 3	12.8	2108623B0
	8.625	8-4D	10"	4	3/4 x 3	16.4	2108624B0
	8.625	8-5D	12"	5	3/4 x 3	19.9	2108625B0
10"	10.750	10-2D	6"	2	3/4 x 3	10.8	2110752B0
	10.750	10-3D	8"	3	3/4 x 3	14.7	2110753B0
	10.750	10-4D	10"	4	3/4 x 3	18.4	2110754B0
	10.750	10-5D	12"	5	3/4 x 3	22.2	2110755B0
12"	12.750	12-2D	6"	2	3/4 x 3	13.1	2112752B0
	12.750	12-3D	8"	3	3/4 x 3	17.7	2112753B0
	12.750	12-4D	10"	4	3/4 x 3	22.3	2112754B0
	12.750	12-5D	12"	5	3/4 x 3	26.8	2112755B0
14"	14.000	14-3D	8"	3	3/4 x 3	18.8	2114003B0
	14.000	14-4D	10"	4	3/4 x 3	23.6	2114004B0
	14.000	14-5D	12"	5	3/4 x 3	28.5	2114005B0

All shipments F.O.B. Erie, PA

Prices subject to change without notice.

*Neoprene